



**PCCO #003**

Burkhardt Construction, Inc.  
 515 Palm St  
 West Palm Beach, Florida 33401  
 Phone: (561) 659-1400

**Project:** 2504 - District 8 - 1st Ave  
 1st Ave ROW to ROW From Hallandale Beach Blvd to NE 5th St  
 Hallandale Beach , Florida 33009

**Prime Contract Change Order #003: Added Speaker System - OPTION 2A & 2B - Ground Mounted Speaker [Hallandale Bch Blvd. to Northern Limits]**

<b>TO:</b>	City of Hallandale Beach 400 South Federal Highway Hallandale Beach, Florida 33009	<b>FROM:</b>	Burkhardt Construction, Inc. 515 Palm Street West Palm Beach Florida 33401
<b>DATE CREATED:</b>	3/ 24 /2026	<b>CREATED BY:</b>	Brandon Rhodes (Burkhardt Construction, Inc.)
<b>CONTRACT STATUS:</b>	Approved	<b>REVISION:</b>	0
<b>REQUEST RECEIVED FROM:</b>		<b>LOCATION</b>	
<b>DESIGNATED REVIEWER:</b>		<b>REVIEWED BY:</b>	
<b>DUE DATE:</b>		<b>REVIEW DATE:</b>	04/07 /2026
<b>REFERENCE:</b>		<b>CHANGE REASON:</b>	Per City Request
<b>EXECUTED:</b>	No	<b>SCHEDULE IMPACT:</b>	
<b>ACCOUNTING METHOD:</b>	Amount Based	<b>CONTRACT FOR:</b>	1:District 8 - 1st Ave
<b>FIELD CHANGE:</b>	No	<b>TOTAL AMOUNT:</b>	\$ 424,485.08

**DESCRIPTION:**  
 A 30 DAY NO COST - TIME EXTENSION IS REQUESTED TO BE A PART OF THIS CO.  
 SPEAKER MOUNT CONCRTE FOUNDATIONS ARE NOT INCLUDED IN THIS PRICING.

**ATTACHMENTS:**  
[2B.pdf](#) [Estimate 9095.pdf](#) [2509.1.01R1 - Sound System Revision Scope of Work and Quotation.pdf](#)

**CHANGE ORDER LINE ITEMS:**

**PCCO #003**

#	Cost Code	Description	Type	Amount
1	16-01600 - Electrical	Infrastructure Installation [Current Connections]	Commitment	\$ 161,580.00
2	16-01600 - Electrical	Ground Mounted Speaker System Installed Including wire and hookup	Commitment	\$ 125,933.47
3	16-01600 - Electrical	Ranger [Sitework Contractor] Downtime ALLOWANCE	Commitment	\$ 31,500.00
4	16-01600 - Electrical	Additional MOT	Commitment	\$ 42,000.00
5	16-01600 - Electrical	BCI 12% Fee for Profit, Insurance, and Bond	Commitment	\$ 43,321.61
6	16-01600 - Electrical	5% Contingency	Commitment	\$ 20,150.00
<b>Subtotal:</b>				<b>\$424,485.08</b>
<b>Grand Total:</b>				<b>\$424,485.08</b>



PCCO #003

The original (Contract Sum)	\$ 8,740,220.86
Net change by previously authorized Change Orders	\$ 147,476.00
The contract sum prior to this Change Order was	\$ 8,887,696.86
The contract sum will be increased by this Change Order in the amount of	\$ 424,485.08
The new contract sum including this Change Order will be	\$ 9,312,181.94
The contract time will not be changed by this Change Order	

City of Hallandale Beach  
 400 South Federal Highway  
 Hallandale Beach Florida 33009

Burkhardt Construction, Inc.  
 515 Palm Street  
 West Palm Beach Florida 33401

\_\_\_\_\_  
 SIGNATURE DATE

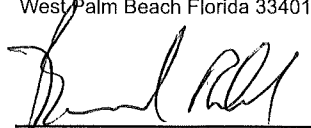
 4/7/26  
 \_\_\_\_\_  
 SIGNATURE DATE



ELECTRICAL CONTRACTOR ⚡ EST. 1984  
1620 Hill Avenue, Mangonia Park, Florida 33407  
(561) 863-0010  
License Number EC-0001253

RECEIVED



March 18, 2026

Burkhardt Construction, Inc.  
515 Palm Street  
West Palm Beach, FL 33401

By BRhodes at 3:12:00 PM, 3/19/2026

**Re: District 8 – NE 1<sup>st</sup> Streetscape Improvements for City of Hallandale  
Sound System Revisions**

Below is a Scope of Work and Quotation for the above project. Our Scope is based on plans by Kimley Horn Associates dated February, 2026, sheets L6.00 – L6.02 and an e-mail from Jonathan Haigh dated March 6, 2026.

**Scope of Work**

**Option 1A – Hallandale Bch. Blvd to NE 3<sup>rd</sup> Street**

**Includes:**

- Installation of 1 – 2” PVC underground conduit with pull string from each Festoon Lighting Pole (4) to the Audio Equipment Head-In location to be determined. (two possibilities are indicated, either are acceptable)
- Installation Audio Head-In location consisting of a ground mounted junction box and a stanchion mounted weather-proof 120v receptacle. The receptacle will be fed from the nearest Power Pedestal.
- Installation of a 13” x 17” x 12”d Ground Mounted Junction Box at each pole location with a 1” conduit looped from the J. Box into the pole cavity for speaker cable provided and installed by others.

**Option 1B – NE 3<sup>rd</sup> Street to Project Northern Limit**

**Includes:**

- Installation of 1 – 2” PVC underground conduit with pull string from each Festoon Lighting Pole (8) to the Audio Equipment Head-In location indicated.
- Installation Audio Head-In location consisting of a ground mounted junction box and a stanchion mounted weather-proof 120v receptacle. The receptacle will be fed from the nearest Power Pedestal.
- Installation of a 13” x 17” x 12”d Ground Mounted Junction Box at each pole location with a 1” conduit looped from the J. Box into the pole cavity for speaker cable provided and installed by others.

**Option 2A – Hallandale Bch. Blvd to NE 3<sup>rd</sup> Street**

**Includes:**

- Installation of a 13” x 17” x 12”d Ground Mounted Junction Box at each ground mounted speaker location indicated (Qty - 22) with a 1” conduit looped from the J. Box to above ground for speaker and speaker cable provided and installed by others.

**Option 2B – NE 3<sup>rd</sup> Street to Project Northern Limit**

**Includes:**

- Installation of a 13” x 17” x 12”d Ground Mounted Junction Box at each ground mounted speaker location indicated (Qty - 13) with a 1” conduit looped from the J. Box to above ground for speaker and speaker cable provided and installed by others.

**Burkhardt Construction, Inc.**  
**District 8 – NE 1<sup>st</sup> Streetscape – Sound System Revisions**  
March 18, 2026  
Page Two

**Excludes:**

- Permit Fees
- Layout and Survey.
- Provision or installation of the Sound System Equipment, Speakers, Head-In Equipment or cabling.

**Cost Breakdown**

Option 1A .....	\$41,300.00
Option 1B .....	\$32,110.00
Option 2A .....	\$109,470.00
Option 2B .....	\$52,110.00

**See attached Bid Form dated 03/18/2026 for additional information.**

Please call me if you have any questions.

Sincerely

Donald Sharkey

**This proposal is valid for 30 days unless otherwise specified in writing.**

**District 8 NE 1st Ave.  
Sound System Raceways**

**Guaranteed Maximum Price**

**Prepared by Current Connections, Inc.**

**Submitted By:**

**Current Connections, Inc.**

**3/18/2025**

**CITY OF HALLANDALE BEACH CRA**

Item Description	Quantity	U/M	Unit Price	Amount
<i>SITE MAINTENANCE OF TRAFFIC (20-21200)</i>				\$0.00
<i>Sound System Raceways - Option 2A</i>				\$ -
				\$ -
				\$ -
				\$109,470.00
				\$ -
				\$ -
				\$ -
PULL BOX - 03/26	28	EA	\$1,350.00	\$ 37,800.00
CONDUIT, FURNISH AND INSTALL OPEN TRENCH - 03/26	590	LF	\$25.00	\$ 14,750.00
CONDUIT, FURNISH AND INSTALL DIRECTIONAL BORE - 03/26	860	LF	\$54.00	\$ 46,440.00
CONDUIT, FURNISH AND INSTALL OPEN TRENCH - Companion 03/26	680	LF	\$11.00	\$ 7,480.00
120V Receptacle w/ Feed to Nearest Power Pedestal	1	EA	\$3,000.00	\$ 3,000.00
				\$ -
				\$ -
				\$ -

**Sound System Raceways Direct Construction Cost Total**

**\$109,470.00**

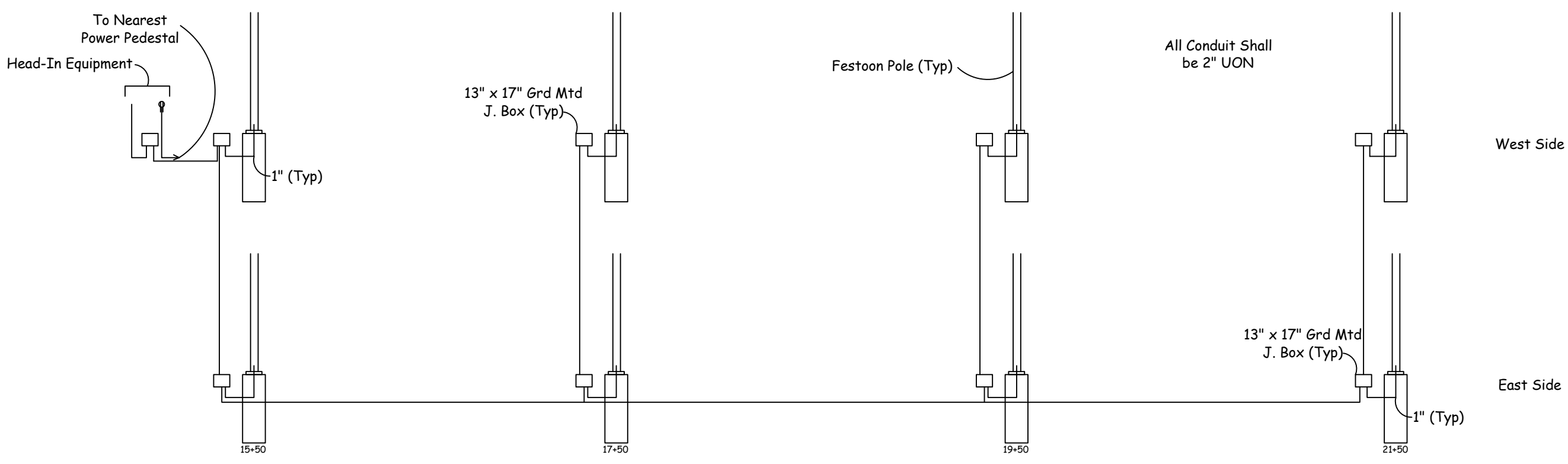

Sheet: 1  
 Of: 2  
 Project No. 2509  
 CONTRACT NO. -----

Drawing Title:  
 Sound System  
 Riser Diagram

Approved:  
 Drawn: as  
 Checked: as  
 Date: 03/17/2028

CURRENT CONNECTIONS, INC.  
 1620 Hill Avenue  
 Mangonia Park, Florida 33407  
 (561) 863-0010 Fax (561) 863-5380  
 State License EC-0001253

Project:  
 District 8 - NE 1st Avenue  
 Streetscape

Scale:  
 N/A

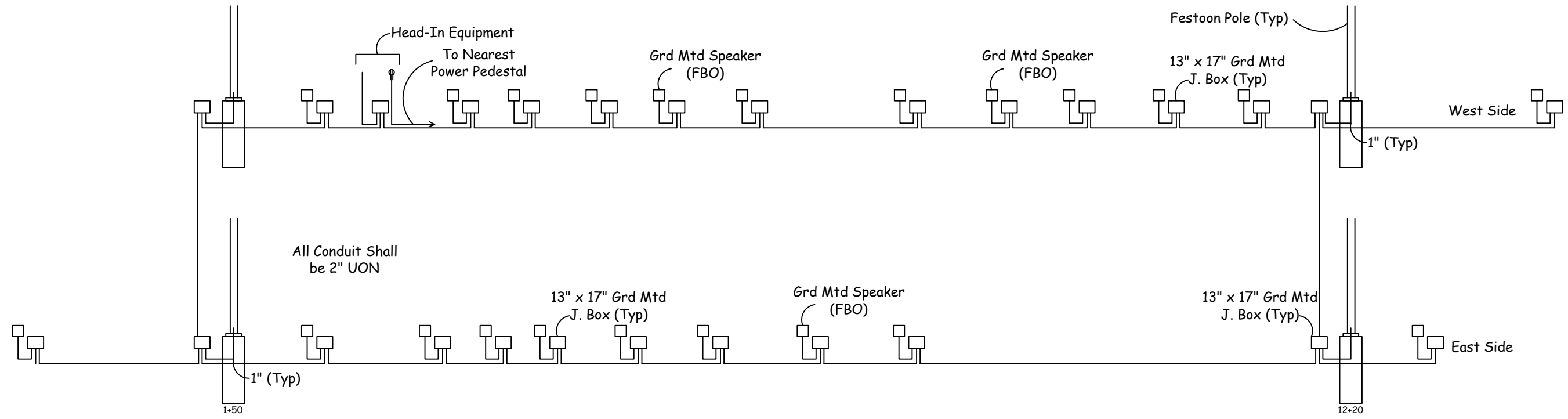

Option 2A

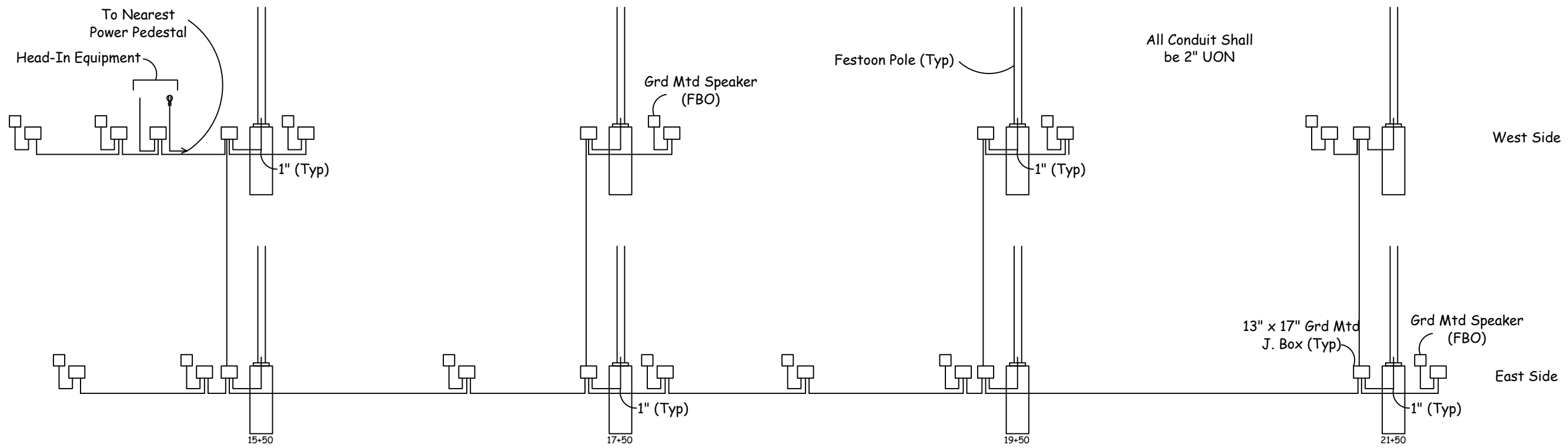

Option 2B

Sheet: 2  
 Of: 2  
 Project No. 2509  
 CONTRACT NO. -----

Drawing Title:  
 Sound System  
 Riser Diagram

Approved:  
 Drawn:     da  
 Checked:   da  
 Date:       03/17/2026

CURRENT CONNECTIONS, INC.  
 1620 Hill Avenue  
 Mangonia Park, Florida 33407  
 (561) 863-0010 Fax (561) 863-5380  
 State License EC-0001253

Project:  
 District 8 - NE 1st Avenue  
 Streetscape

Scale:  
 N/A

This document, together with the concepts and designs presented herein, is an instrument of service, and its preparation, execution, and use are subject to the terms and conditions of the contract between the client and the consultant. It is to be used only for the specific purpose and scope for which it was prepared. No part of this document may be reproduced or transmitted in any form or by any means, electronic or mechanical, including photocopying, recording, or by any information storage and retrieval system, without the prior written permission of the consultant.

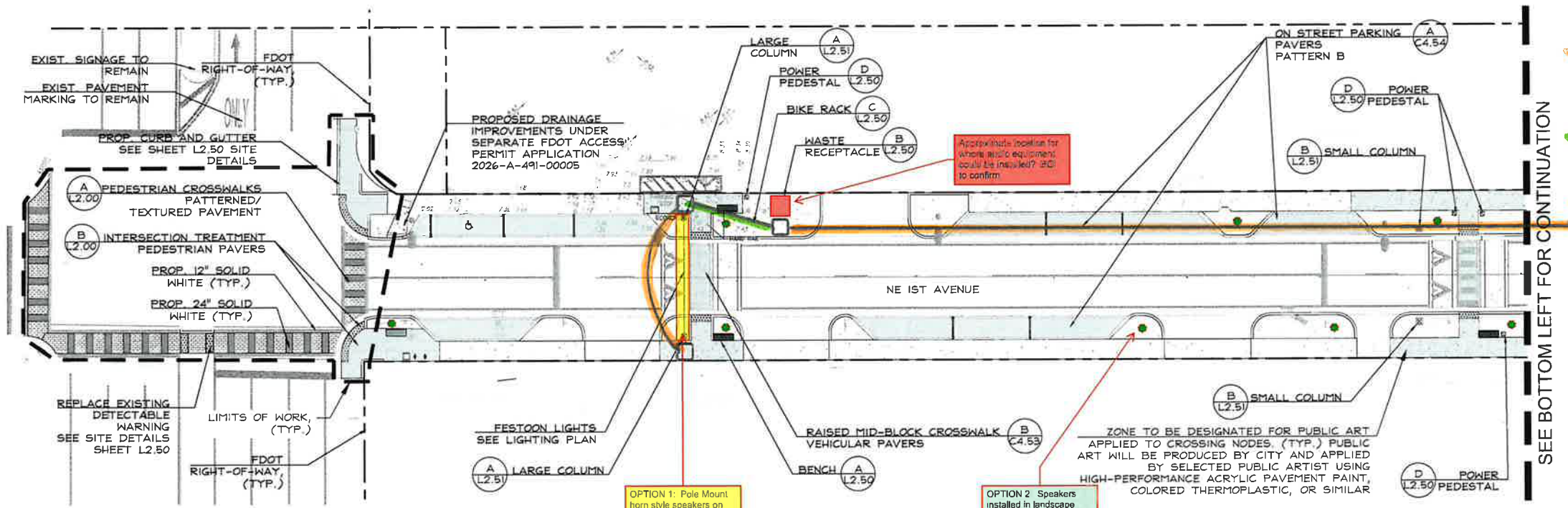

— Direct Drive

— Conduit

— Conduit

SEE BOTTOM LEFT FOR CONTINUATION

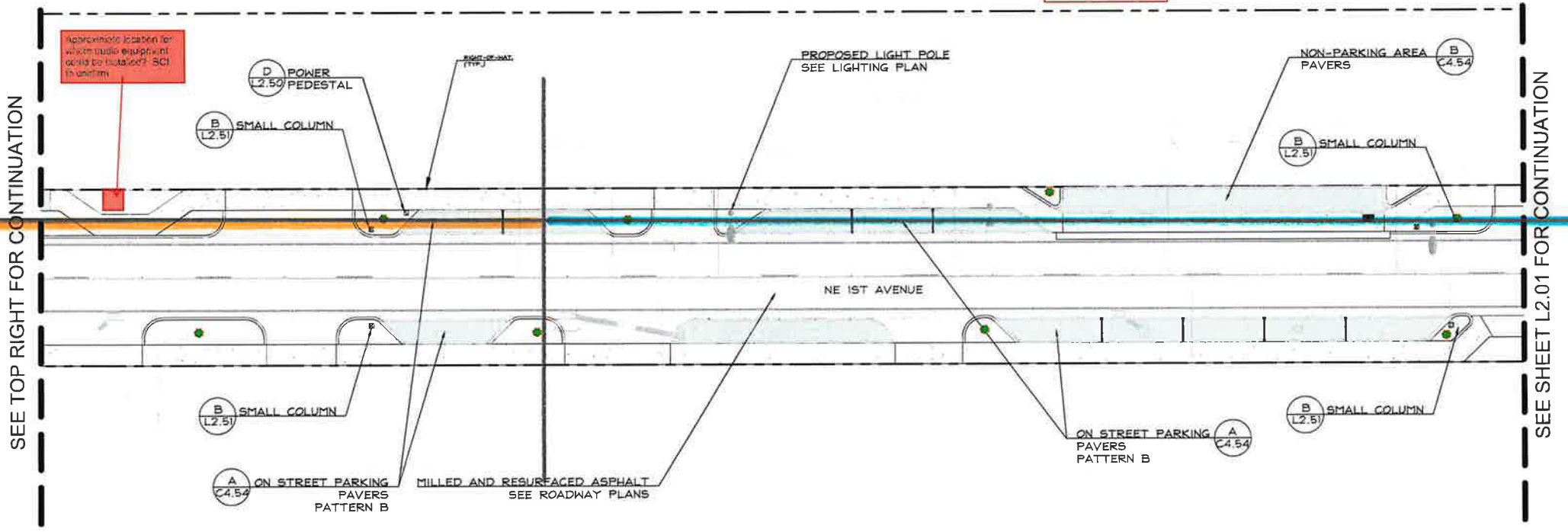

SEE TOP RIGHT FOR CONTINUATION

SEE SHEET L2.01 FOR CONTINUATION



LOCATION MAP  
 SCALE: 1" = 400'

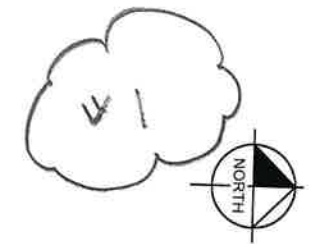

GRAPHIC SCALE IN FEET  
 0 10 20 40

CALL 48 HOURS BEFORE YOU DIG  
**811**  
 IT'S THE LAW! DIAL 811 Know what's below. Call before you dig.  
 SUNSHINE STATE ONE CALL OF FLORIDA, INC.

<b>Kimley»Horn</b> 2025 W. WILEY HORN AND ASSOCIATES, INC. 1970 W. VIA WAY SUITE 200 WEST PALM BEACH, FL 33411 PHONE: 561-853-0885 FAX: 561-863-8178 WWW.KIMLEY-HORN.COM CA 00000590		REVISIONS NO. DATE BY
KHA PROJECT: 24102-0001 DATE: FEB 2026 DRAWN BY: JH CHECKED BY: JH DATE: 2/13/2026	LICENSE NUMBER: LA#6566735 EXPIRES: 2/13/2026	PROJECT: DISTRICT 8 - NE 1ST STREETSCAPE IMPROVEMENTS PREPARED FOR HALLANDALE BEACH CRA SHEET NUMBER: L2.00

This document is the property of Kimley-Horn and Associates, Inc. It is to be used only for the specific project and site for which it was prepared. No part of this document may be reproduced or transmitted in any form or by any means electronic or mechanical, including photocopying, recording, or by any information storage and retrieval system, without written permission from Kimley-Horn and Associates, Inc.

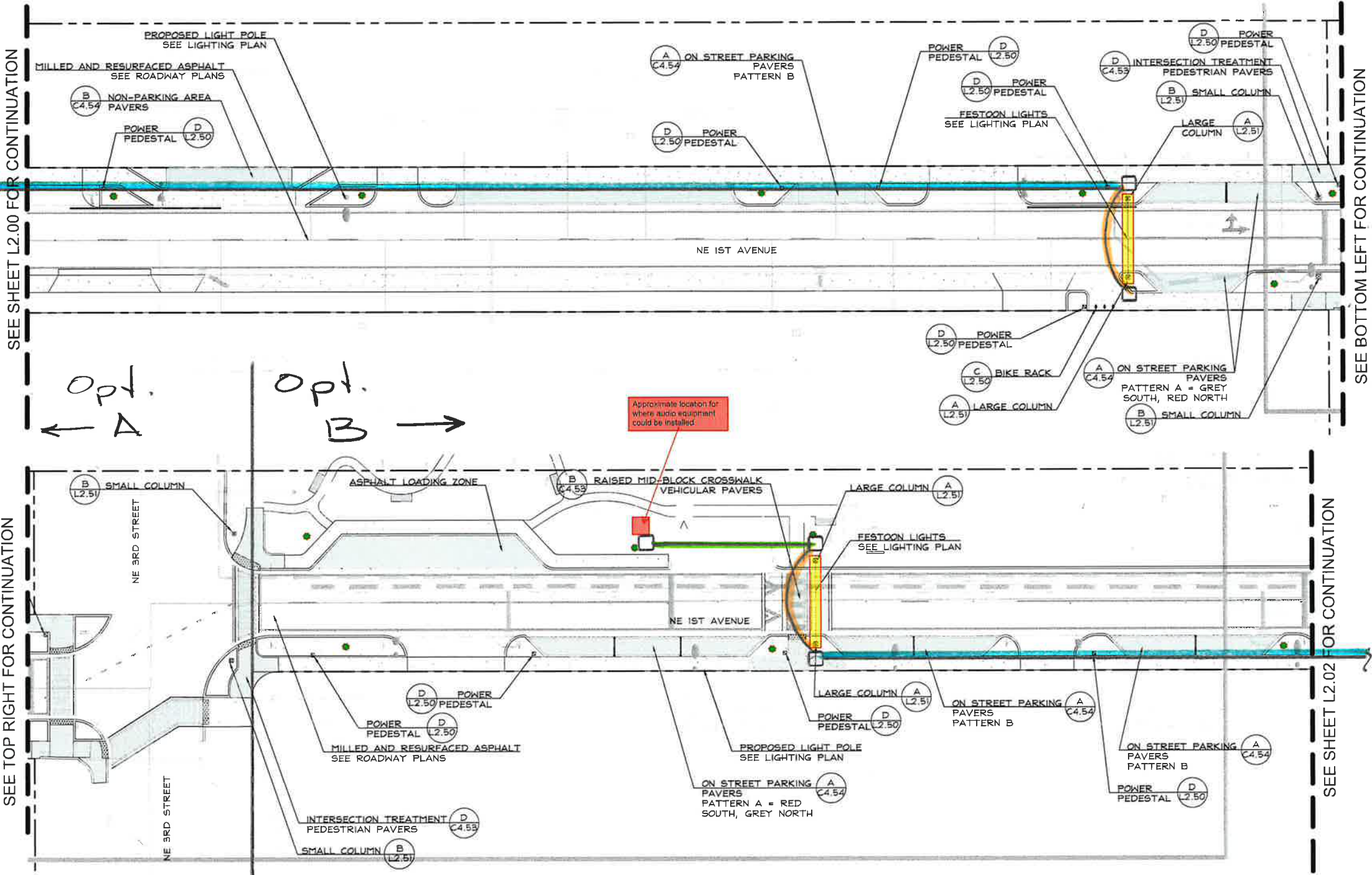

SEE SHEET L2.00 FOR CONTINUATION

SEE TOP RIGHT FOR CONTINUATION

SEE SHEET L2.02 FOR CONTINUATION

SEE BOTTOM LEFT FOR CONTINUATION

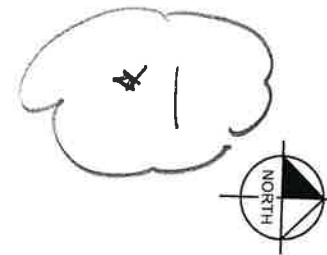

LOCATION MAP  
SCALE: 1" = 400'

CALL 48 HOURS BEFORE YOU DIG  
**811**  
 IT'S THE LAW!  
 DIAL 811  
 Know what's below.  
 Call before you dig.  
 SUNSHINE STATE ONE CALL OF FLORIDA, INC.

<b>Kimley Horn</b> 1970 WEST PALM WAY SUITE 200 WEST PALM BEACH, FL 33411 PHONE: 561-973-0865 FAX: 561-983-8175 WWW.KIMLEY-HORN.COM CA 00000030	
KHA PROJ.C 241040001	L-ENG-3-DRG-000A
DATE 11-15-2024	JOWYHEN D. -HIGH, PLA
DRAWN BY YAWN IV, DH	LICENSE NUMBER LA16566795
CHECKED BY JH	DATE 2/13/2026
<b>HARDSCAPE PLAN</b>	
DISTRICT 8 - NE 1ST STREETSCAPE IMPROVEMENTS PREPARED FOR HALLANDALE BEACH CRA	
SHEET NUMBER <b>L2.01</b>	
REVISIONS	DATE BY

This document, together with the concepts and designs presented herein, is the property of Kimley-Horn and Associates, Inc. and shall remain the property of Kimley-Horn and Associates, Inc. It is to be used only for the specific purpose and client for which it was prepared. No part of this document may be reproduced or transmitted in any form or by any means, electronic, mechanical, photocopying, recording, or by any information storage and retrieval system, without written permission from Kimley-Horn and Associates, Inc.

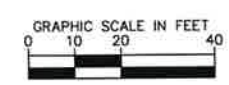
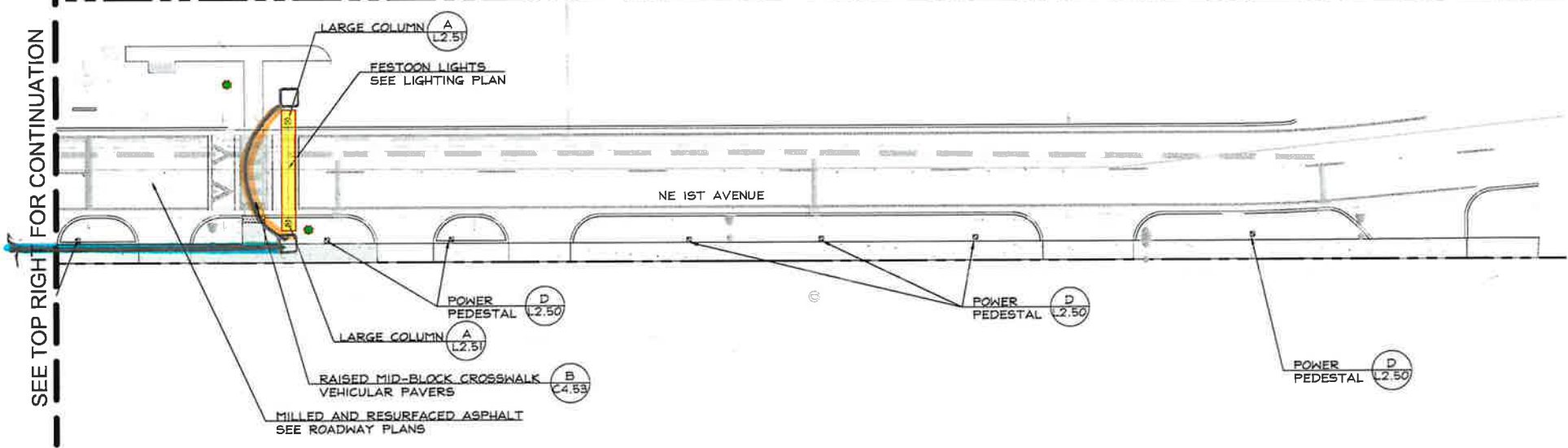
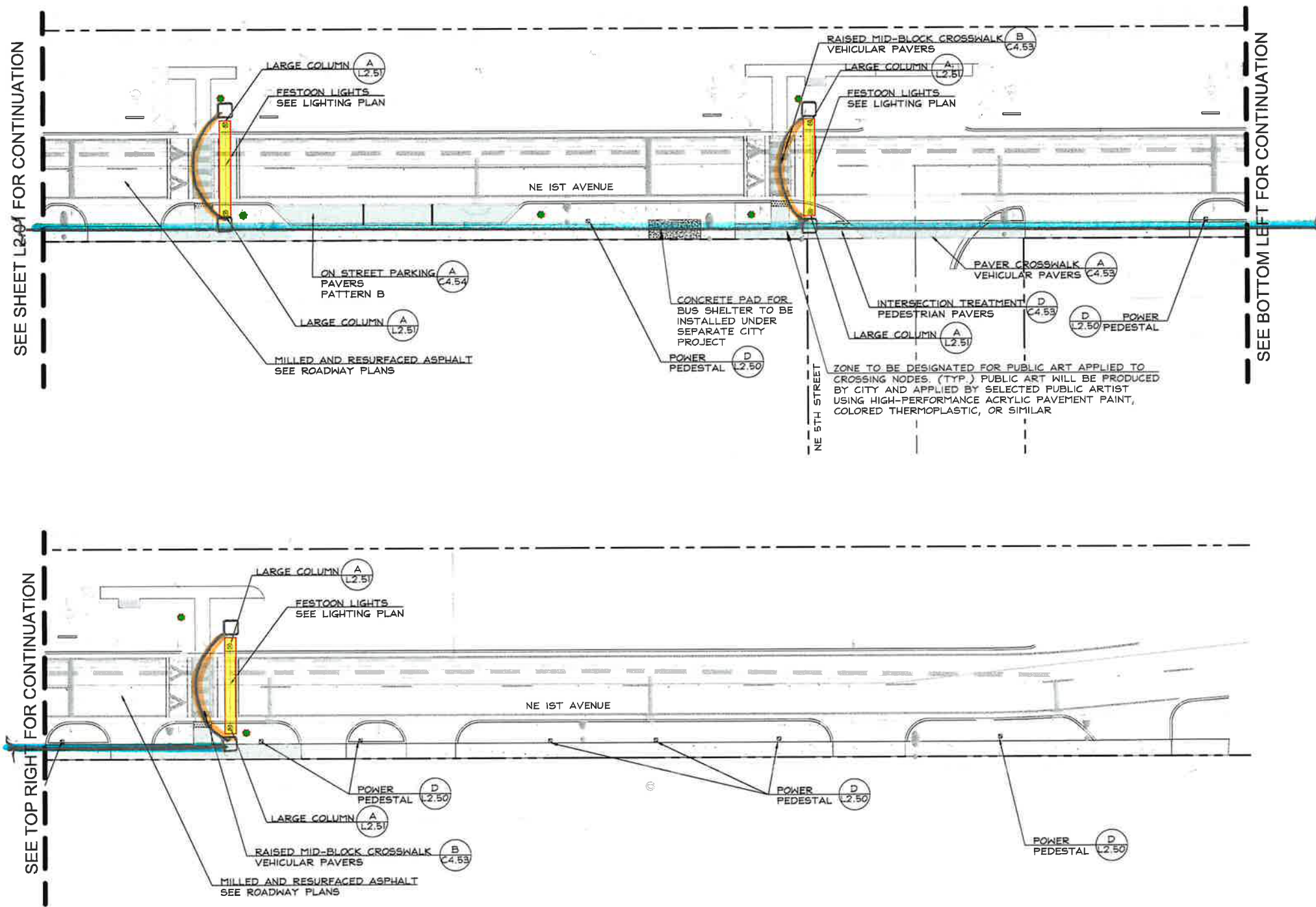

LOCATION MAP  
 SCALE: 1" = 400'

CALL 48 HOURS BEFORE YOU DIG  
 IT'S THE LAW! DIAL 811  
  
 Know what's below. Call before you dig.  
 SUNSHINE STATE ONE CALL OF FLORIDA, INC.

<b>DISTRICT 8 - NE 1ST STREETScape IMPROVEMENTS PREPARED FOR HALLANDALE BEACH CRA</b> HALLANDALE BEACH	SHEET NUMBER <b>L2.02</b>	<b>HARDSCAPE PLAN</b>	KHA PROJ. C 241040001	I. CLIENT: PROFESSIONAL	<b>Kimley»Horn</b> © 2025 KIMLEY-HORN AND ASSOCIATES, INC. 1970 W. VA WAY S.W. FT. WEST PALM BEACH, FL 33411 PHONE: 561-863-8175 WWW.KIMLEY-HORN.COM CA 00000996	REVISIONS No. _____ BY _____ DATE _____
			DATE FEB 2026	JOYATHAN D. HAIGH, P.E. FL LICENSE NUMBER LA#6666195		

This document, together with the concepts and designs presented herein, is prepared only for the specific purpose and client for which it was prepared. No other use or reuse of any part of this document is permitted without the written authorization and approval of Kimley-Horn and Associates, Inc. No part of this document shall be reproduced, stored in a retrieval system, or transmitted in any form or by any means, electronic, mechanical, photocopying, recording, or by any information storage and retrieval system, without the prior written permission of Kimley-Horn and Associates, Inc.

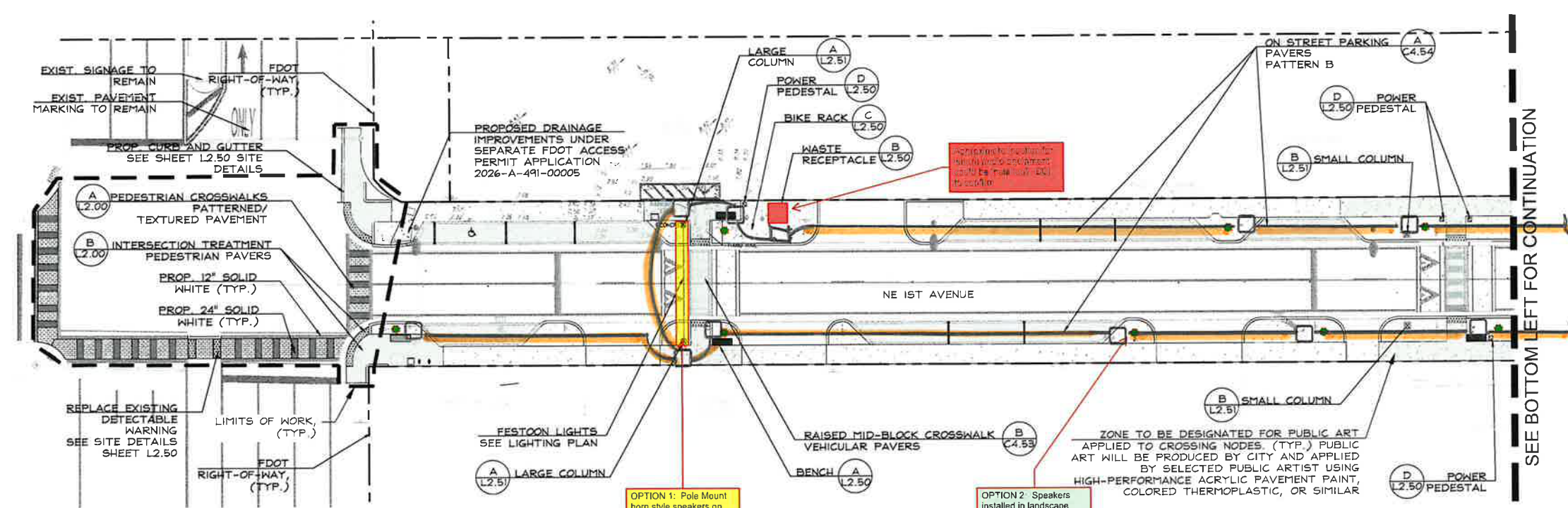

- Direct Burial

- Conduit

- Conduit

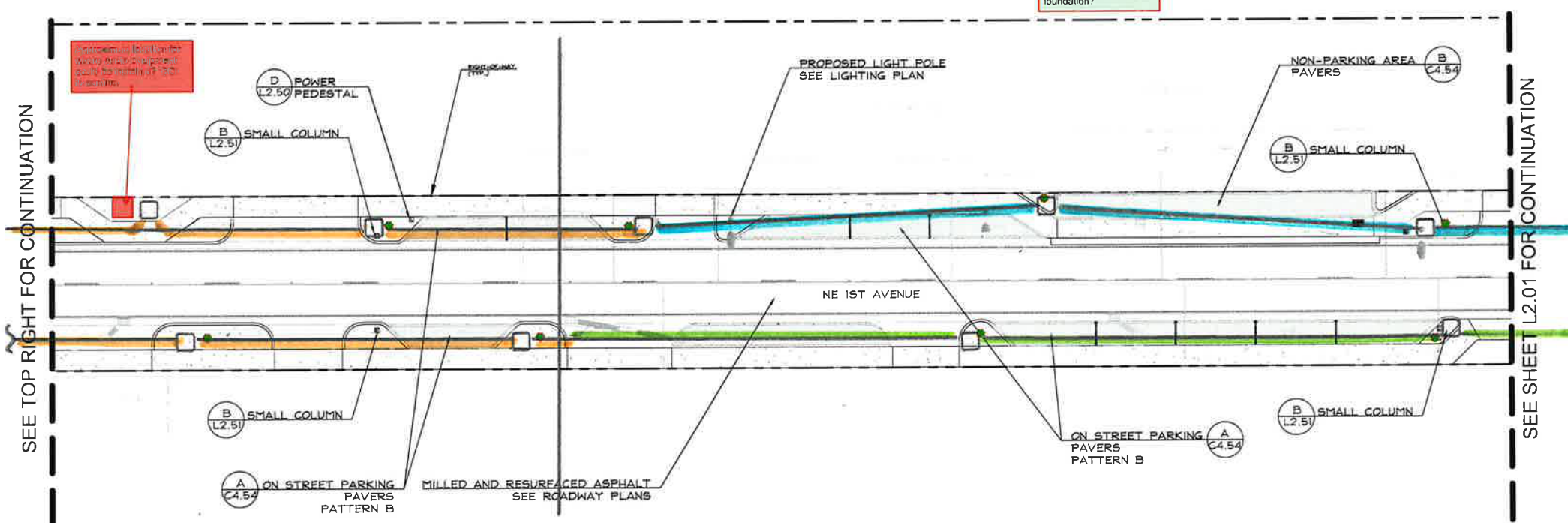

SEE TOP RIGHT FOR CONTINUATION

SEE BOTTOM LEFT FOR CONTINUATION

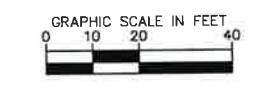
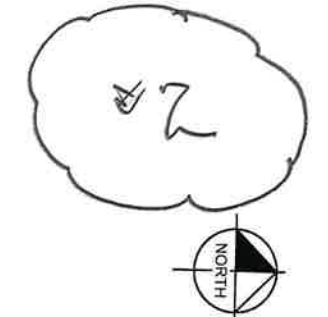

LOCATION MAP SCALE: 1" = 400'

CALL 48 HOURS BEFORE YOU DIG  
 IT'S THE LAW! DIAL 811  
 Know what's below. Call before you dig.  
 SUNSHINE STATE ONE CALL OF FLORIDA, INC.

<b>Kimley»Horn</b> <small>© 2025 KIMLEY-HORN AND ASSOCIATES, INC.          1926 W. V. A. WAY S.J. FT. PDC, WEST PALM BEACH, FL 33411          PHONE: 561-875-0665 FAX: 561-883-8175          WWW.KIMLEY-HORN.COM CA 00000050</small>		No. _____ REVISIONS _____ DATE _____ BY _____
LICENSED PROFESSIONAL ENGINEER JOYFATH D. HORN, P.E. FL LICENSE NUMBER LA#65666/35 DATE: 2/13/2026	KHA PROJ. C: 2410/0001 DATE: FEB 2026 SCALE: AS SHOWN DRAWN BY: JH CHECKED BY: JH DATE: 2/13/2026	DISTRICT 8 - NE 1ST STREETSCAPE IMPROVEMENTS PREPARED FOR HALLANDALE BEACH CRA SHEET NUMBER: L2.00

This document, together with the contents and designs presented herein, is the property of Kimley-Horn and Associates, Inc. and shall be held in confidence. It is to be used only for the specific purpose and site for which it was prepared. Reproduction or other use without written authorization and approval by Kimley-Horn and Associates, Inc. shall be without liability to Kimley-Horn and Associates, Inc.

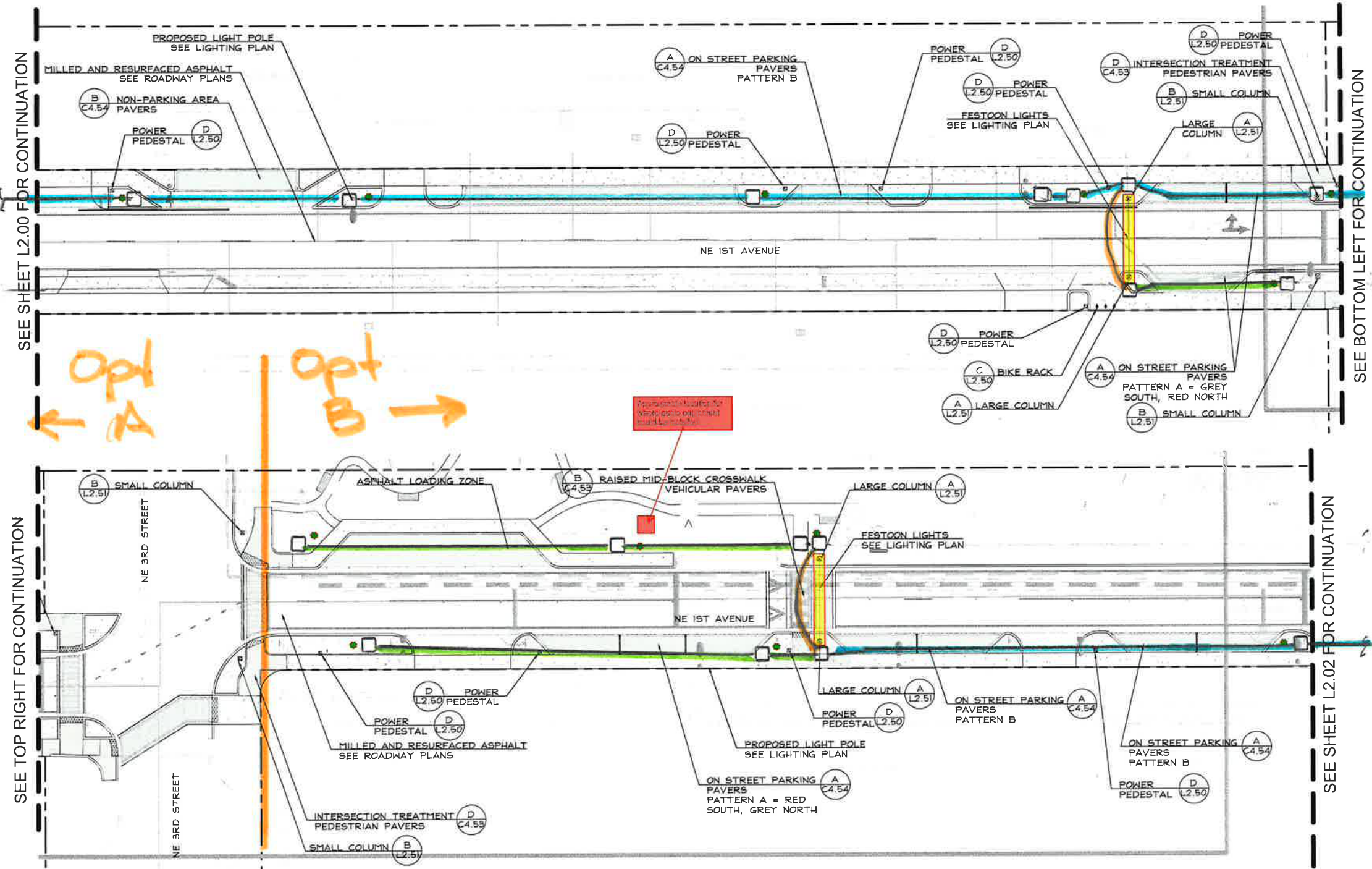

SEE SHEET L2.00 FOR CONTINUATION

SEE SHEET L2.02 FOR CONTINUATION



LOCATION MAP  
SCALE: 1" = 400'

CALL 48 HOURS BEFORE YOU DIG

IT'S THE LAW! DIAL 811

**811**

Know what's below. Call before you dig.

SUNSHINE STATE ONE CALL OF FLORIDA, INC.

<b>DISTRICT 8 - NE 1ST STREETSCAPE IMPROVEMENTS PREPARED FOR HALLANDALE BEACH CRA</b>		<b>HARDSCAPE PLAN</b>		<b>Kimley»Horn</b> © 2025 KIMLEY-HORN AND ASSOCIATES, INC. 1920 W. VA. WAY, SUITE 200, WEST PALM BEACH, FL 33411 PHONE: 561-974-0686 FAX: 561-863-8175 WWW.KIMLEY-HORN.COM CA 00000086	
SHEET NUMBER <b>L2.01</b>		DATE FEB 2026		PROJECT NUMBER LA165633/95	
PREPARED BY JH		CHECKED BY JH		DATE 2/13/2026	
DRAWN BY JH		SCALE AS SHOWN		LICENSE NUMBER LA165633/95	
PROJECT NAME DISTRICT 8 - NE 1ST STREETSCAPE IMPROVEMENTS		CLIENT HALLANDALE BEACH, FLA		REVISIONS No. DATE BY	

This document, together with the concepts and designs presented herein, is an instrument of service, as an instrument of service, as defined in Florida Statute 218.30, and shall be read in conjunction with the contract documents for the project. It is intended only for the specific purpose and client for which it was prepared. No part of this document shall be reproduced or transmitted in any form or by any means, electronic or mechanical, including photocopying, recording, or by any information storage and retrieval system, without the prior written permission of Kimley-Horn and Associates, Inc. All rights reserved.

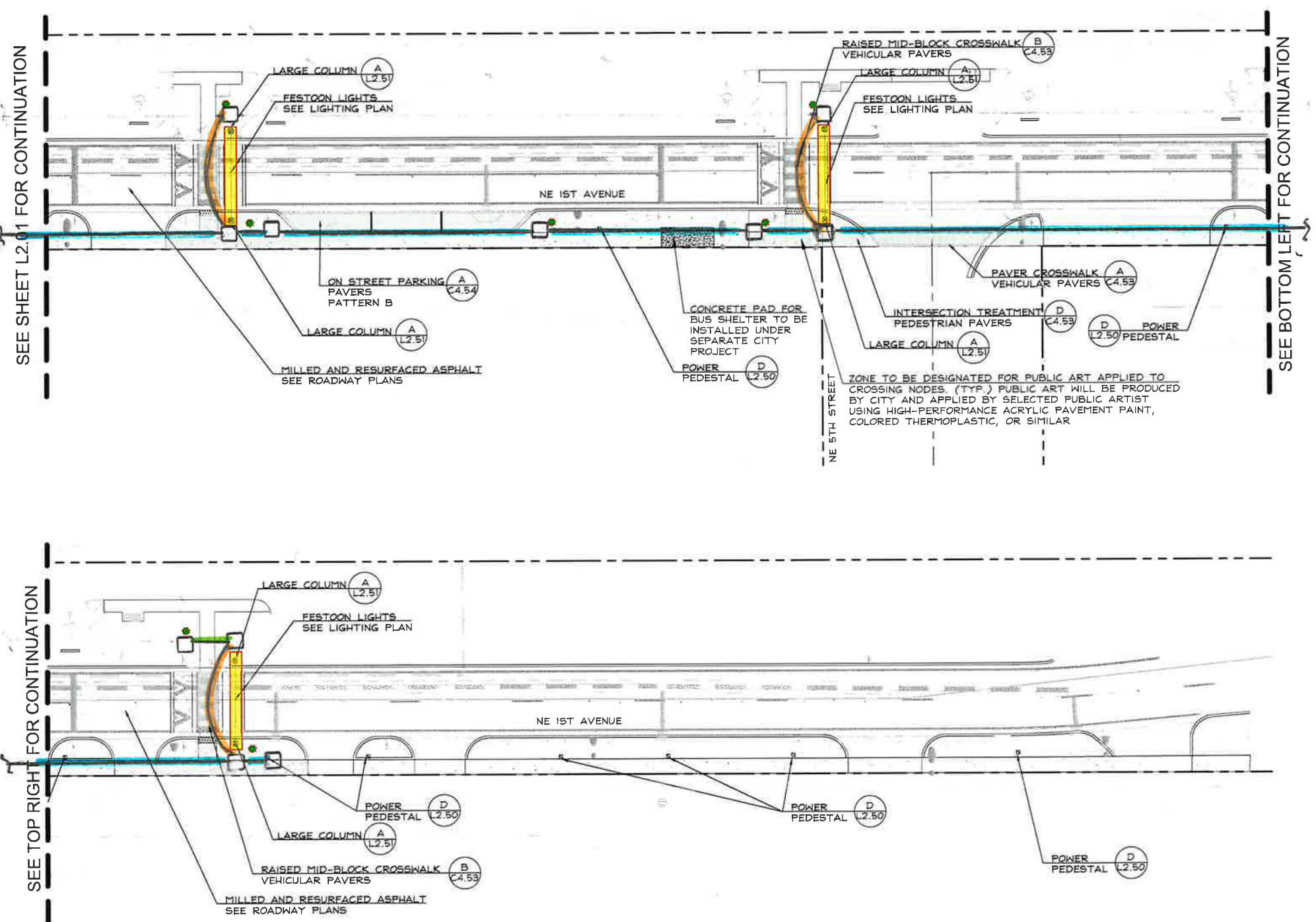

SEE TOP RIGHT FOR CONTINUATION

SEE BOTTOM LEFT FOR CONTINUATION



LOCATION MAP  
SCALE: 1"=400'

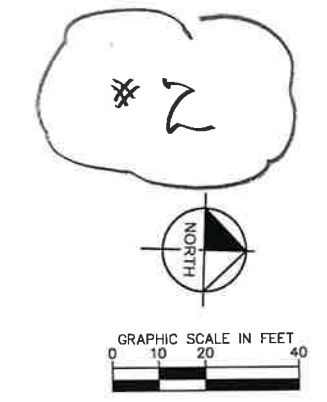

CALL 48 HOURS BEFORE YOU DIG

**811**

IT'S THE LAW! DIAL 811

Know what's below. Call before you dig.

FLORIDA STATE ONE CALL OF FLORIDA, INC.

<p><b>Kimley»Horn</b></p> <p>© 2025 KIMLEY-HORN AND ASSOCIATES, INC. 1920 W. VA. WAY, SUITE 200, WEST PALM BEACH, FL 33411 PHONE: 561-973-0865 FAX: 561-863-8175 WWW.KIMLEY-HORN.COM CA 00030596</p>	
<p>KHA PROJECT: 2410-C001</p> <p>DATE: FEB 2026</p> <p>DRAWN BY: JH</p> <p>CHECKED BY: JH</p> <p>DATE: 2/13/2026</p>	<p>LICENSING: PROFESSIONAL ENGINEER</p> <p>JOVATHAN D. HATH, P.E.</p> <p>FLORIDA LICENSE NUMBER: LA#6666795</p>
<p><b>HARDSCAPE PLAN</b></p>	
<p>DISTRICT 8 - NE 1ST STREETSCAPE IMPROVEMENTS PREPARED FOR HALLANDALE BEACH CRA</p>	
<p>SHEET NUMBER: L2.02</p>	
<p>REVISIONS</p>	<p>DATE</p>



**ER Tech Systems Group Inc.**

2450 NW 36th Street  
 Ste 1A  
 Pompano Beach, FL 33073 US  
 +15615784964  
 admin@broadcastsystemsinc.com  
 www.broadcastsystemsinc.com

**Estimate**

ADDRESS	SHIP TO	SHIP VIA	GROUND	ESTIMATE	9095
BURKHARDT CONSTRUCTION, INC. 1400 Alabama Avenue, Suite 20 West Palm Beach, FL 33401	BURKHARDT CONSTRUCTION, INC. 1400 Alabama Avenue, Suite 20 West Palm Beach, FL 33401			DATE	03/15/2026

SALES REP  
 Nicholas Ehr

ACTIVITY	DESCRIPTION	QTY	RATE	AMOUNT
	OPTION 2A: Hallandale Beach Boulevard to 3rd St: Ground-mounted speakers – installed in landscape areas.			
Atlas IED	Atlas IED All Weather Outdoor Landscape Speaker with Short Base and 32-Watt 70V Transformer GSS-G TAP 32W @70V	30	921.193537	27,635.81T
Atlas IED	Atlas IED Dual-Channel, 1300-Watt Commercial Amplifier HPA1302	1	1,718.95	1,718.95T
BrightSign	BrightSign AU335 Audio Player IP Based with web control	1	165.00	165.00T
Job Materials	Peplink BR mini with din rail kit, extended range ANTENNA, AND POWER SUPPLY	1	1,120.00	1,120.00T
Job Materials	APC SMT1000RM1U Smart-UPS Line Interactive, Rack-Mountable, 1000VA, LCD Display	1	1,038.906	1,038.91T
Job Materials	BrightSign Cloud management software 1 year subscription DDB OD-16DDC 18"H x 28"W x 39"D (7 RU*) enclosure DDB Wall mount DDB insulation kit DDB Locking kit 2 handles Pentair AC unit for enclosure SS version OVP HV surge LV Surge Mounting materials and other consumable items	1	8,791.83	8,791.83T
Job Materials	Wirepath SP-142-DB-500-BLK 14/2 Direct Burial Speaker Wire, 500' Drum, Black	10	499.99	4,999.90T
Master Tech	Master Tech 1 tech 5 days	40	130.00	5,200.00T
Technician	Technician 2 techs 5 days	80	100.00	8,000.00T
Programming	Programming	8	160.00	1,280.00T
Project Mgmt	Project Management	8	150.00	1,200.00T

Pricing does not include directional drill/ missile bore,  
permitting, and any delay claims by Ranger.

You can pay by ACH, there's no fee for this option  
All estimates are inclusive of materials and completion of labor known at the  
time of site inspection. If extra materials and hours are required after work has  
begun, Broadcast Systems will inform the customer as soon as this knowledge  
is obtained. Once approved, a 50% deposit is required for work to begin. We do  
accept credit cards for payment. However, there will be a charge of 3.5% of the  
total purchase.  
Permitting, design, and engineering fees will be billed at cost plus. 2%

SUBTOTAL	61,150.40
TAX	4,280.53
-----	
TOTAL	<b>\$65,430.93</b>

Accepted By

Accepted Date



ELECTRICAL CONTRACTOR ⚡ EST. 1984  
1620 Hill Avenue, Mangonia Park, Florida 33407  
(561) 863-0010  
License Number EC-0001253

RECEIVED



March 18, 2026

Burkhardt Construction, Inc.  
515 Palm Street  
West Palm Beach, FL 33401

By BRhodes at 3:12:00 PM, 3/19/2026

**Re: District 8 – NE 1<sup>st</sup> Streetscape Improvements for City of Hallandale  
Sound System Revisions**

Below is a Scope of Work and Quotation for the above project. Our Scope is based on plans by Kimley Horn Associates dated February, 2026, sheets L6.00 – L6.02 and an e-mail from Jonathan Haigh dated March 6, 2026.

**Scope of Work**

**Option 1A – Hallandale Bch. Blvd to NE 3<sup>rd</sup> Street**

**Includes:**

- Installation of 1 – 2” PVC underground conduit with pull string from each Festoon Lighting Pole (4) to the Audio Equipment Head-In location to be determined. (two possibilities are indicated, either are acceptable)
- Installation Audio Head-In location consisting of a ground mounted junction box and a stanchion mounted weather-proof 120v receptacle. The receptacle will be fed from the nearest Power Pedestal.
- Installation of a 13” x 17” x 12”d Ground Mounted Junction Box at each pole location with a 1” conduit looped from the J. Box into the pole cavity for speaker cable provided and installed by others.

**Option 1B – NE 3<sup>rd</sup> Street to Project Northern Limit**

**Includes:**

- Installation of 1 – 2” PVC underground conduit with pull string from each Festoon Lighting Pole (8) to the Audio Equipment Head-In location indicated.
- Installation Audio Head-In location consisting of a ground mounted junction box and a stanchion mounted weather-proof 120v receptacle. The receptacle will be fed from the nearest Power Pedestal.
- Installation of a 13” x 17” x 12”d Ground Mounted Junction Box at each pole location with a 1” conduit looped from the J. Box into the pole cavity for speaker cable provided and installed by others.

**Option 2A – Hallandale Bch. Blvd to NE 3<sup>rd</sup> Street**

**Includes:**

- Installation of a 13” x 17” x 12”d Ground Mounted Junction Box at each ground mounted speaker location indicated (Qty - 22) with a 1” conduit looped from the J. Box to above ground for speaker and speaker cable provided and installed by others.

**Option 2B – NE 3<sup>rd</sup> Street to Project Northern Limit**

**Includes:**

- Installation of a 13” x 17” x 12”d Ground Mounted Junction Box at each ground mounted speaker location indicated (Qty - 13) with a 1” conduit looped from the J. Box to above ground for speaker and speaker cable provided and installed by others.

**Burkhardt Construction, Inc.**  
**District 8 – NE 1<sup>st</sup> Streetscape – Sound System Revisions**  
March 18, 2026  
Page Two

**Excludes:**

- Permit Fees
- Layout and Survey.
- Provision or installation of the Sound System Equipment, Speakers, Head-In Equipment or cabling.

**Cost Breakdown**

<b>Option 1A .....</b>	<b>\$41,300.00</b>
<b>Option 1B .....</b>	<b>\$32,110.00</b>
<b>Option 2A .....</b>	<b>\$109,470.00</b>
<b>Option 2B .....</b>	<b>\$52,110.00</b>

**See attached Bid Form dated 03/18/2026 for additional information.**

Please call me if you have any questions.

Sincerely

Donald Sharkey

**This proposal is valid for 30 days unless otherwise specified in writing.**

**District 8 NE 1st Ave.  
Sound System Raceways**

**Guaranteed Maximum Price**

**Prepared by Current Connections, Inc.**

**Submitted By:**

**Current Connections, Inc.**

**3/18/2025**

**CITY OF HALLANDALE BEACH CRA**

Item Description	Quantity	U/M	Unit Price	Amount
<i>SITE MAINTENANCE OF TRAFFIC (20-21200)</i>				\$0.00
<i>Sound System Raceways - Option 2B</i>				\$ -
				\$52,110.00
				\$ -
				\$ -
				\$ -
PULL BOX - 03/26	19	EA	\$1,350.00	\$ 25,650.00
CONDUIT, FURNISH AND INSTALL OPEN TRENCH - 03/26	320	LF	\$25.00	\$ 8,000.00
CONDUIT, FURNISH AND INSTALL DIRECTIONAL BORE - 03/26	160	LF	\$54.00	\$ 8,640.00
CONDUIT, FURNISH AND INSTALL OPEN TRENCH - Companion 03/26	620	LF	\$11.00	\$ 6,820.00
120V Receptacle w/ Feed to Nearest Power Pedestal	1	EA	\$3,000.00	\$ 3,000.00
				\$ -
				\$ -
				\$ -

**Sound System Raceways Direct Construction Cost Total**

**\$52,110.00**

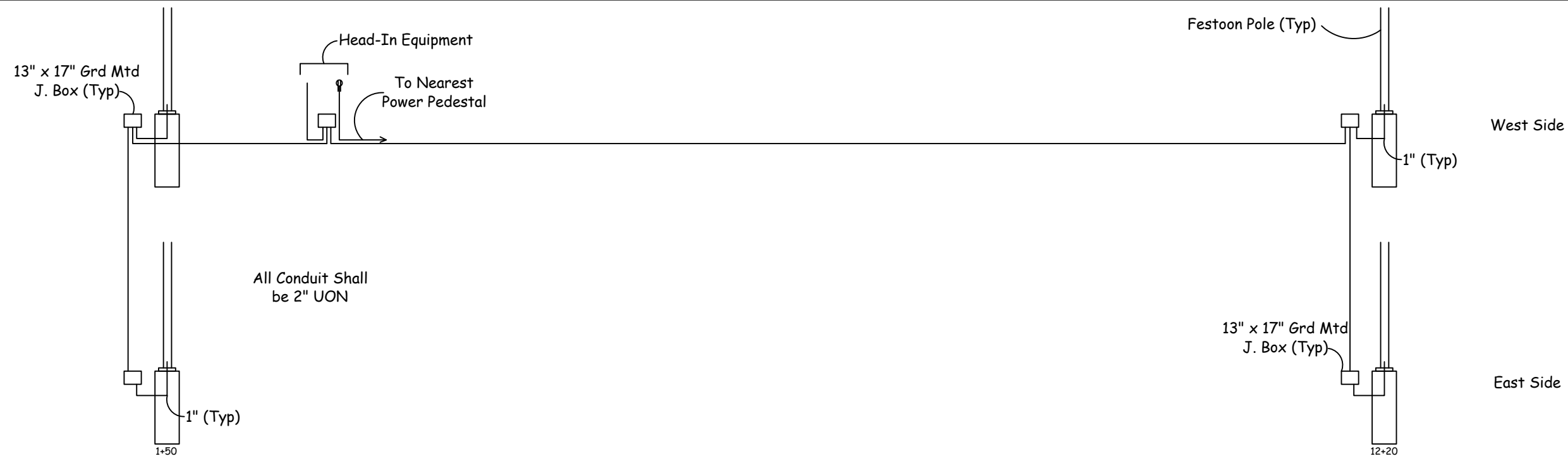

Option 1A

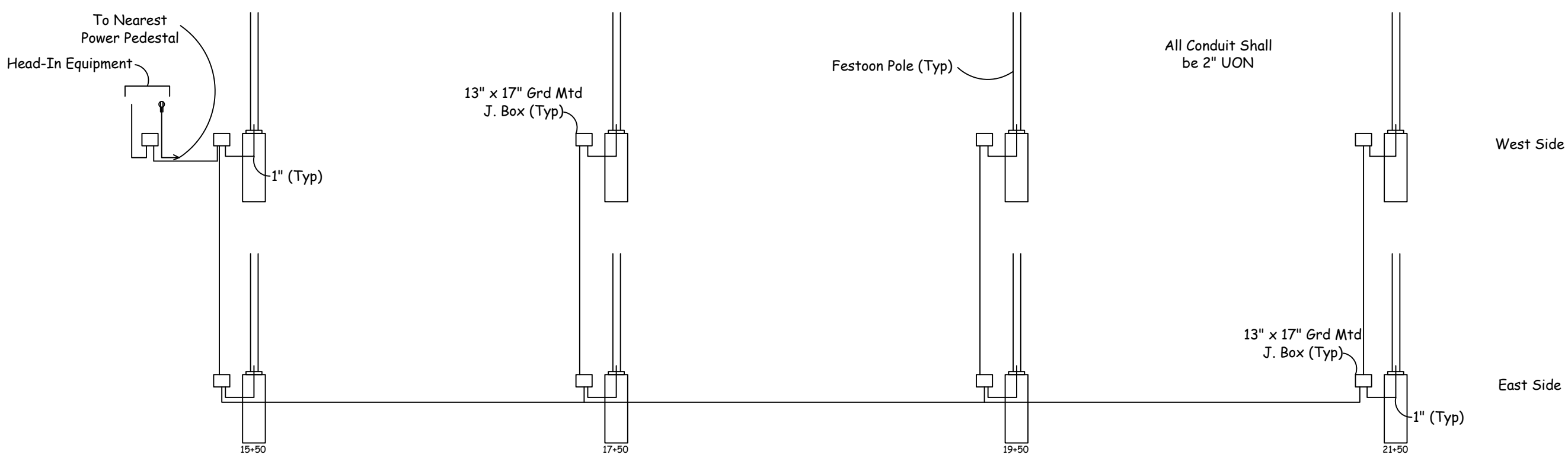

Option 1B

Sheet: 1  
Of: 2  
Project No. 2509  
Contract No. -----

Drawing Title:  
Sound System  
Riser Diagram

Approved: \_\_\_\_\_  
Drawn: \_\_\_\_\_  
Checked: \_\_\_\_\_  
Date: 03/17/2028

**CURRENT CONNECTIONS, INC.**  
1620 Hill Avenue  
Mangonia Park, Florida 33407  
(561) 863-0010 Fax (561) 863-5380  
State License EC-0001253

Project:  
District 8 - NE 1st Avenue  
Streetscape

Scale:  
N/A

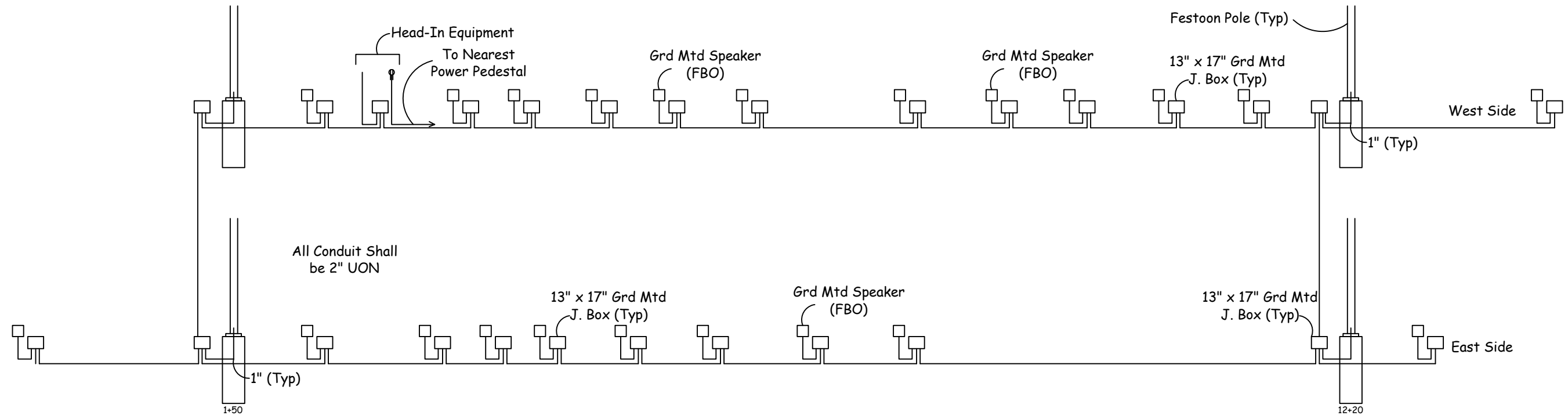

Option 2A

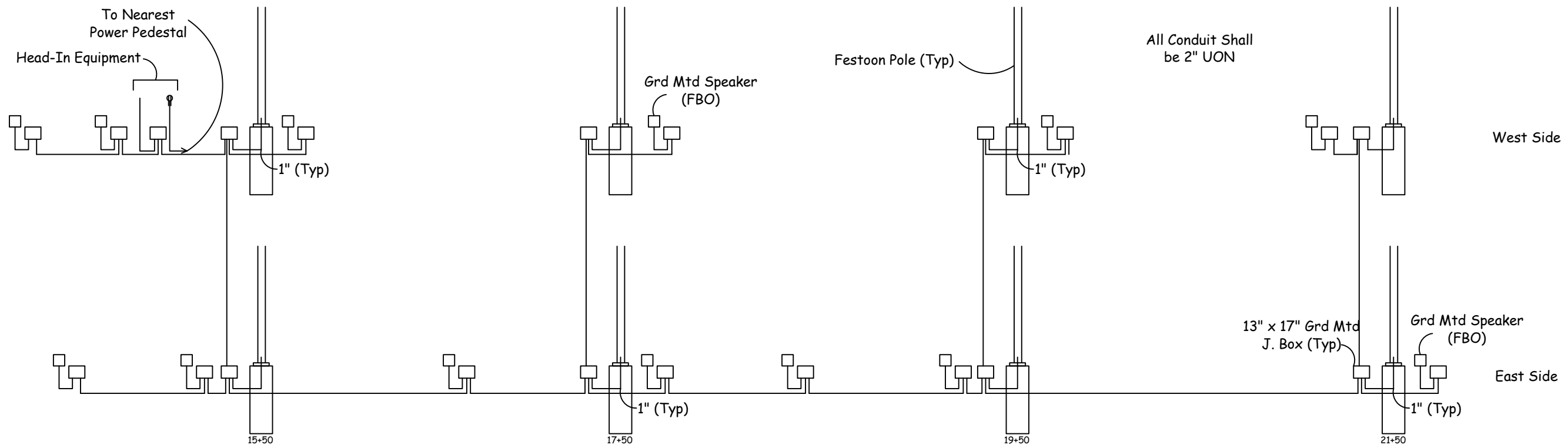

Option 2B

Sheet: 2  
Of: 2  
Project No. 2509  
CONTRACT NO. -----

Drawing Title:  
Sound System  
Riser Diagram

Approved:  
Drawn:     da  
Checked:   da  
Date:      03/17/2026

CURRENT CONNECTIONS, INC.  
1620 Hill Avenue  
Mangonia Park, Florida 33407  
(561) 863-0010 Fax (561) 863-5380  
State License EC-0001253

Project:  
District 8 - NE 1st Avenue  
Streetscape

Scale:  
N/A

This document, together with the concepts and designs presented herein, is an instrument of service, and its preparation, execution, and use are subject to the terms and conditions of the contract between the client and the consultant. It is to be used only for the specific purpose and scope for which it was prepared. No part of this document may be reproduced or transmitted in any form or by any means, electronic or mechanical, including photocopying, recording, or by any information storage and retrieval system, without the prior written permission of the consultant.

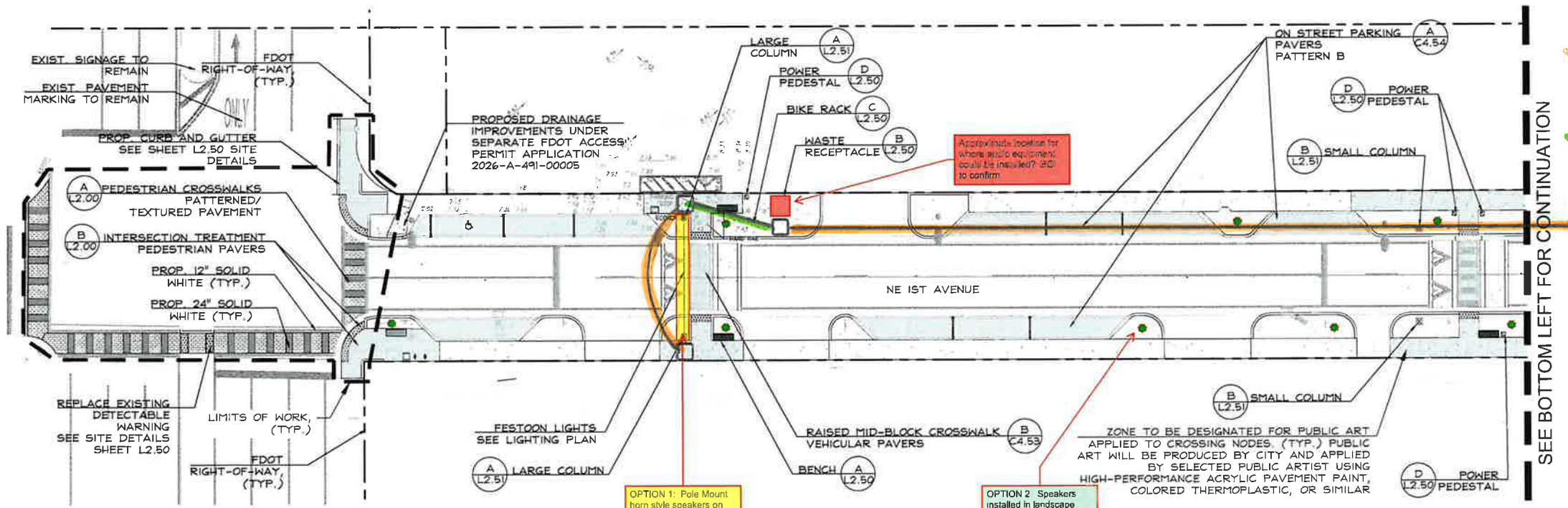

— Direct Drive

— Conduit

— Conduit

SEE BOTTOM LEFT FOR CONTINUATION

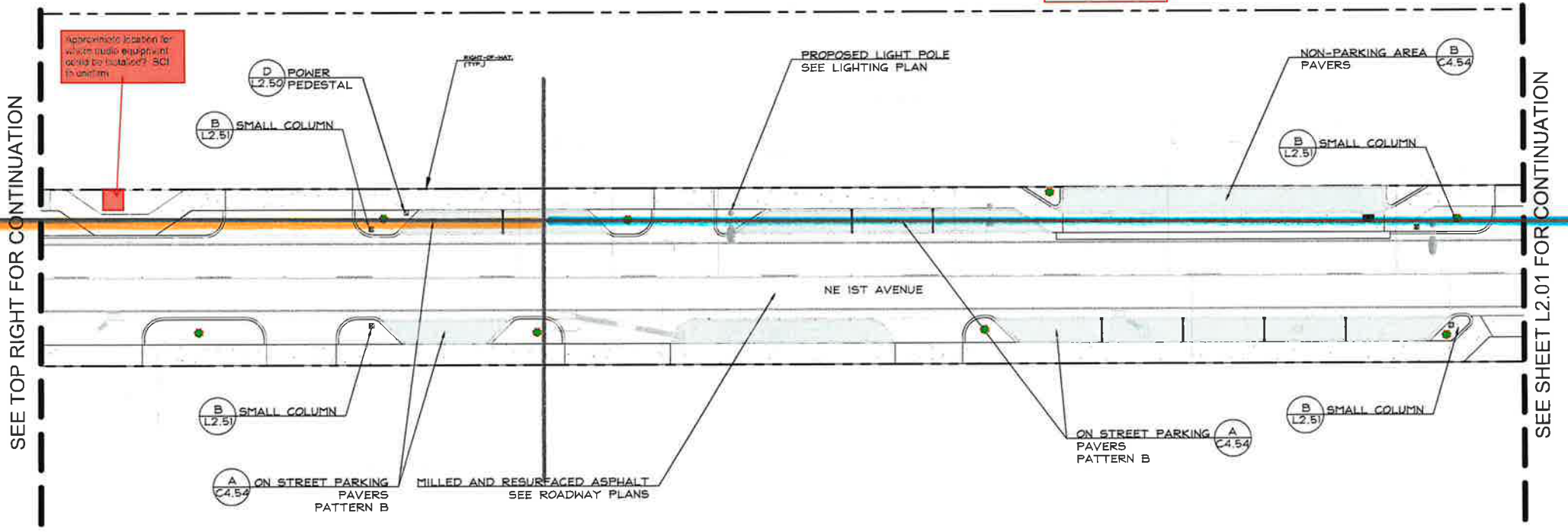

SEE TOP RIGHT FOR CONTINUATION

SEE SHEET L2.01 FOR CONTINUATION



LOCATION MAP  
 SCALE: 1" = 400'

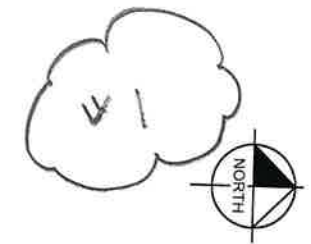

GRAPHIC SCALE IN FEET  
 0 10 20 40

CALL 48 HOURS BEFORE YOU DIG  
 IT'S THE LAW! DIAL 811  
 Know what's below. Call before you dig.  
 SUNSHINE STATE ONE CALL OF FLORIDA, INC.

<b>Kimley»Horn</b> 2025 W. WILEY FORE AND ASSOCIATES, INC. 1970 W. VIA WAY SUITE 200 WEST PALM BEACH, FL 33411 PHONE: 561-853-0885 FAX: 561-863-8178 WWW.KIMLEY-HORN.COM CA 00000590		REVISIONS NO. DATE BY
KHA PROJECT: 24102-0001 DATE: FEB 2026 DRAWN BY: JH CHECKED BY: JH DATE: 2/13/2026	LICENSE NUMBER: LA#65666735 EXPIRES: 2/13/2026	PROJECT: DISTRICT 8 - NE 1ST STREETSCAPE IMPROVEMENTS PREPARED FOR HALLANDALE BEACH CRA SHEET NUMBER: L2.00

This document, together with the contract and design approved herein, shall be held in confidence and shall not be used for any other project without the written consent of Kimley-Horn and Associates, Inc. No part of this document shall be reproduced or transmitted in any form or by any means, electronic, mechanical, photocopying, recording, or by any information storage and retrieval system, without the prior written permission of Kimley-Horn and Associates, Inc.

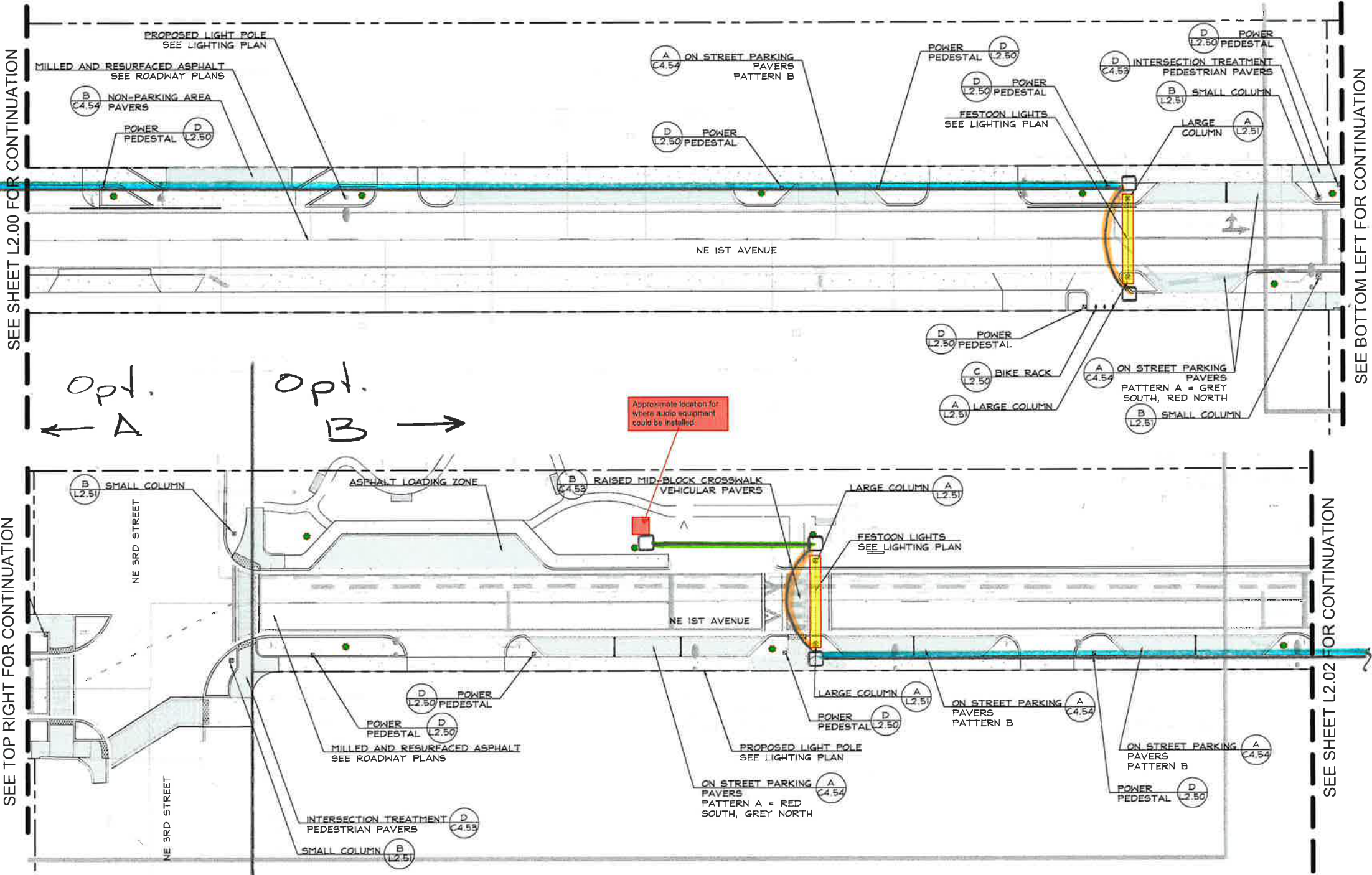

SEE SHEET L2.00 FOR CONTINUATION

SEE TOP RIGHT FOR CONTINUATION

SEE BOTTOM LEFT FOR CONTINUATION

SEE SHEET L2.02 FOR CONTINUATION

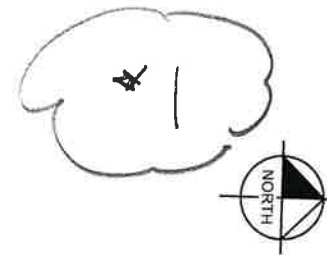

LOCATION MAP SCALE: 1" = 400'

CALL 48 HOURS BEFORE YOU DIG  
 IT'S THE LAW! DIAL 811  
 Know what's below. Call before you dig.  
 SUNSHINE STATE ONE CALL OF FLORIDA, INC.

<b>Kimley»Horn</b> <small>© 2025 KIMLEY HORN AND ASSOCIATES, INC.          1972 WEST PALM WAY SUITE 200 WEST PALM BEACH, FL 33411          PHONE: 561-973-0865 FAX: 561-983-8175          WWW.KIMLEY-HORN.COM CA 00000030</small>	
KHA PROJ.C 241040001	L-ENG-3-DRG-000A
DATE 11-13-2025	JOWYHEN D. -HIGH, PLA
DRAWN BY YAWN IV, DH	LICENSE NUMBER LA165666795
CHECKED BY JH	DATE 2/13/2026
<b>HARDSCAPE PLAN</b>	
DISTRICT 8 - NE 1ST STREETSCAPE IMPROVEMENTS PREPARED FOR HALLANDALE BEACH CRA	
SHEET NUMBER <b>L2.01</b>	
REVISIONS	DATE BY

This document, together with the concepts and designs presented herein, is the property of Kimley-Horn and Associates, Inc. and shall remain the property of Kimley-Horn and Associates, Inc. without written authorization and approval by Kimley-Horn and Associates, Inc. and shall be without liability to Kimley-Horn and Associates, Inc.

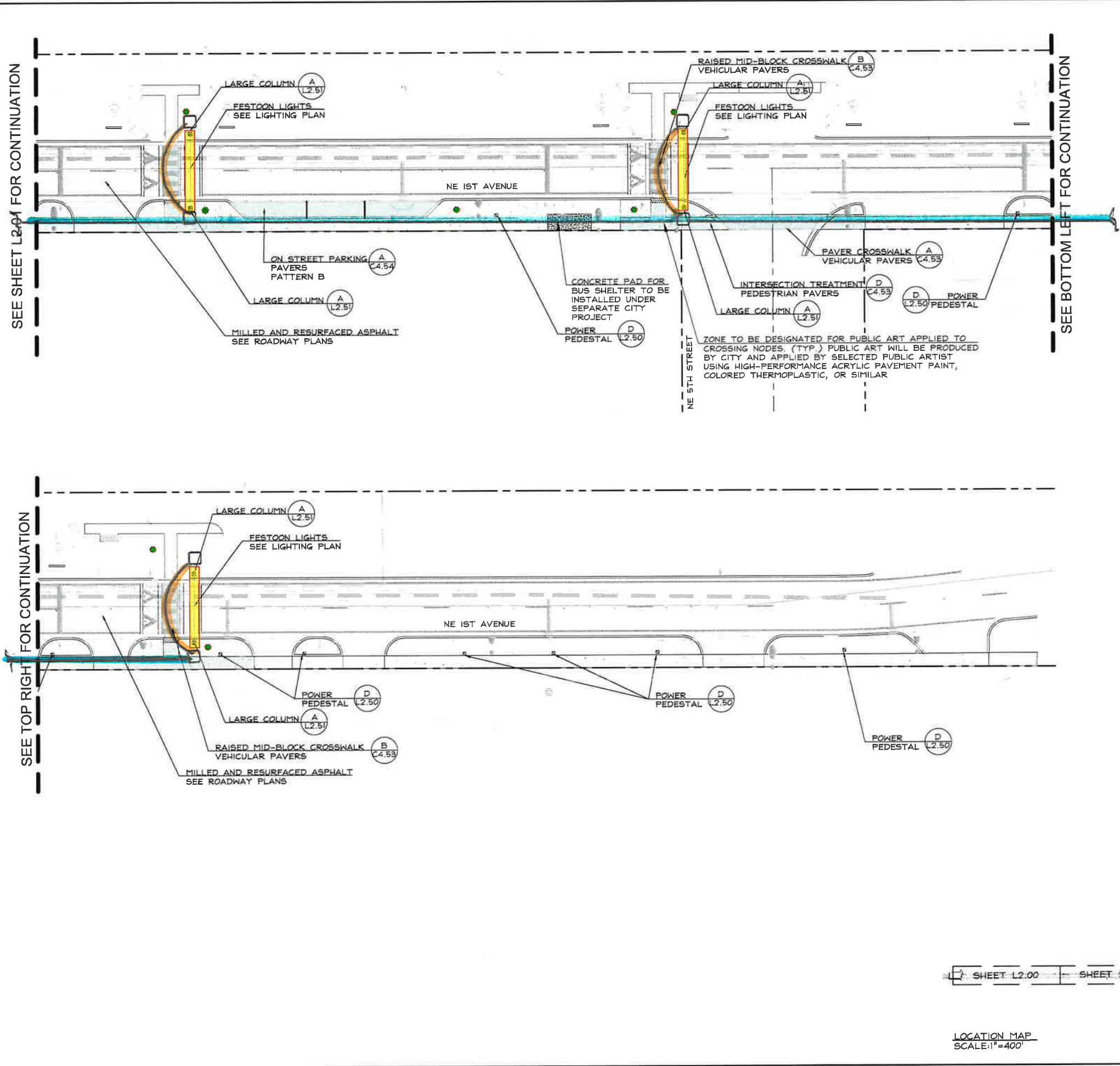

SEE SHEET L2.01 FOR CONTINUATION

SEE TOP RIGHT FOR CONTINUATION

SEE BOTTOM LEFT FOR CONTINUATION

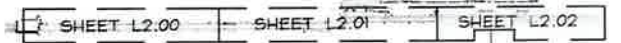
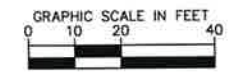

LOCATION MAP  
SCALE: 1" = 400'

CALL 48 HOURS BEFORE YOU DIG  
IT'S THE LAW! DIAL 811  
Know what's below. Call before you dig.  
SUNSHINE STATE ONE CALL OF FLORIDA, INC.

<b>DISTRICT 8 - NE 1ST STREETScape IMPROVEMENTS PREPARED FOR HALLANDALE BEACH CRA</b> HALLANDALE BEACH	<b>HARDSCAPE PLAN</b>	KHA PROJ. C 241040001 DATE FEB 2026 SCALE AS SHOWN DRAWN BY JAH/jh CHECKED BY JH	I.C. STATE PROFESSIONAL JONATHAN D. HAIGH, P.E. FL LICENSE NUMBER LA#6666/95 DATE 2/13/2026	REVISIONS No. _____ DATE _____ BY _____
		© 2025 KIMLEY-HORN AND ASSOCIATES, INC. 1970 W. VA. WAY S.W. FT. WORTH, TX 76102 PHONE 817-335-0885 FAX 817-335-0886 WWW.KIMLEY-HORN.COM CA 00000896		
SHEET NUMBER <b>L2.02</b>				

This document, together with the concepts and designs presented herein, is prepared only for the specific purpose and client for which it was prepared. No other use or reuse of any part of this document is permitted without the written authorization and approval of Kimley-Horn and Associates, Inc. No part of this document shall be reproduced, stored in a retrieval system, or transmitted in any form or by any means, electronic, mechanical, photocopying, recording, or by any information storage and retrieval system, without the prior written permission of Kimley-Horn and Associates, Inc.

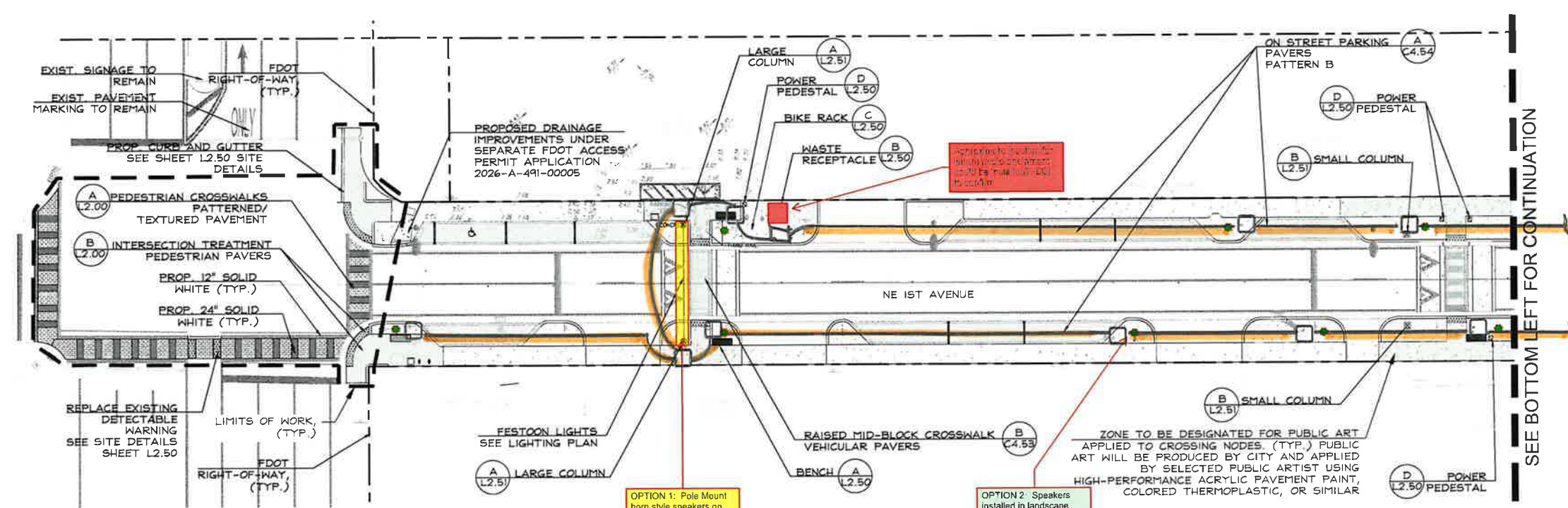

- Direct Burial

- Conduit

- Conduit

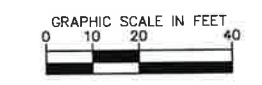
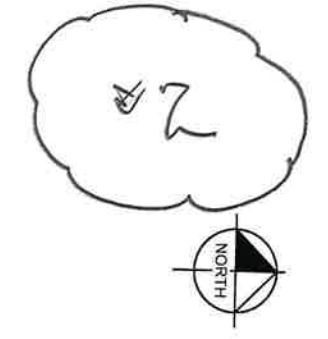
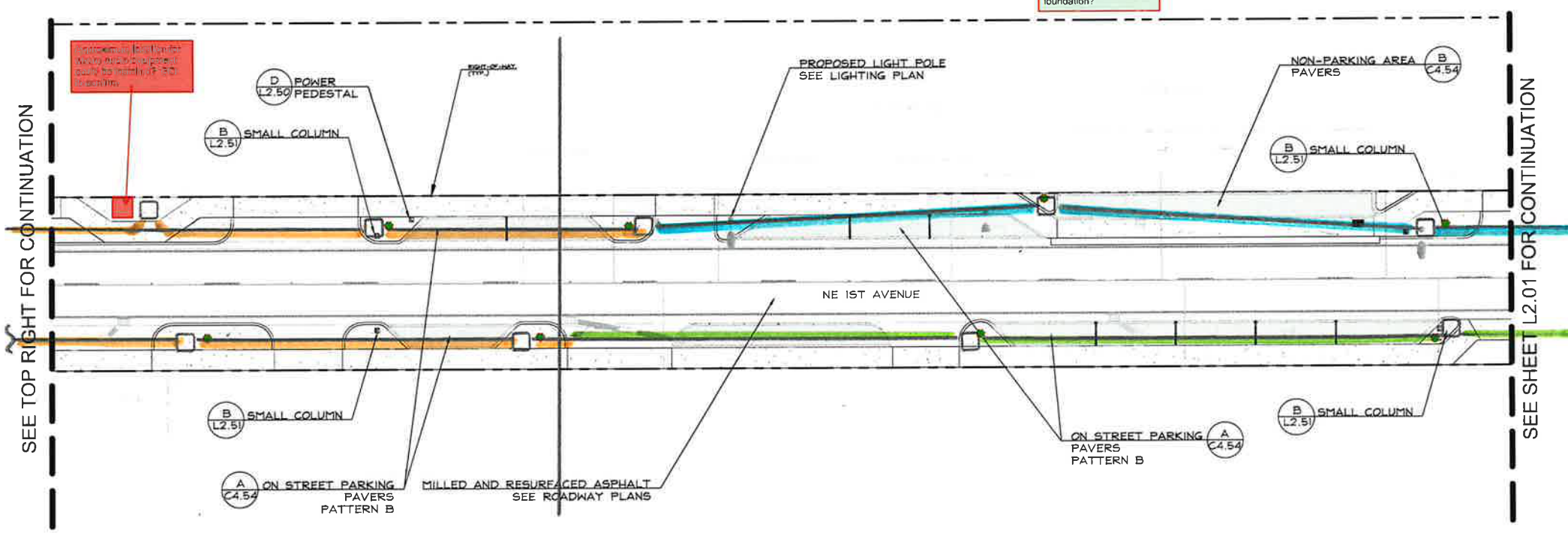

LOCATION MAP  
 SCALE: 1" = 400'

CALL 48 HOURS BEFORE YOU DIG  
 IT'S THE LAW! DIAL 811  
 Know what's below. Call before you dig.  
 SUNSHINE STATE ONE CALL OF FLORIDA, INC.

<b>Kimley»Horn</b> <small>© 2025 KIMLEY-HORN AND ASSOCIATES, INC.          1926 W. V. A. WAY, SUITE 200, WEST PALM BEACH, FL 33411          PHONE: 561-875-0665 FAX: 561-883-8175          WWW.KIMLEY-HORN.COM CA 00000050</small>	
PROJECT: DISTRICT 8 - NE 1ST STREETSCAPE IMPROVEMENTS SHEET: L2.00	DATE: FEB 2026 DRAWN BY: JH CHECKED BY: JH DATE: 2/13/2026
HALLANDALE BEACH CRA	

This document, together with the contents and designs presented herein, is the property of Kimley-Horn and Associates, Inc. and is to be used only for the specific purpose and project for which it was prepared. Reuse or modification of any part of this document without written authorization and approval by Kimley-Horn and Associates, Inc. shall be without liability to Kimley-Horn and Associates, Inc.

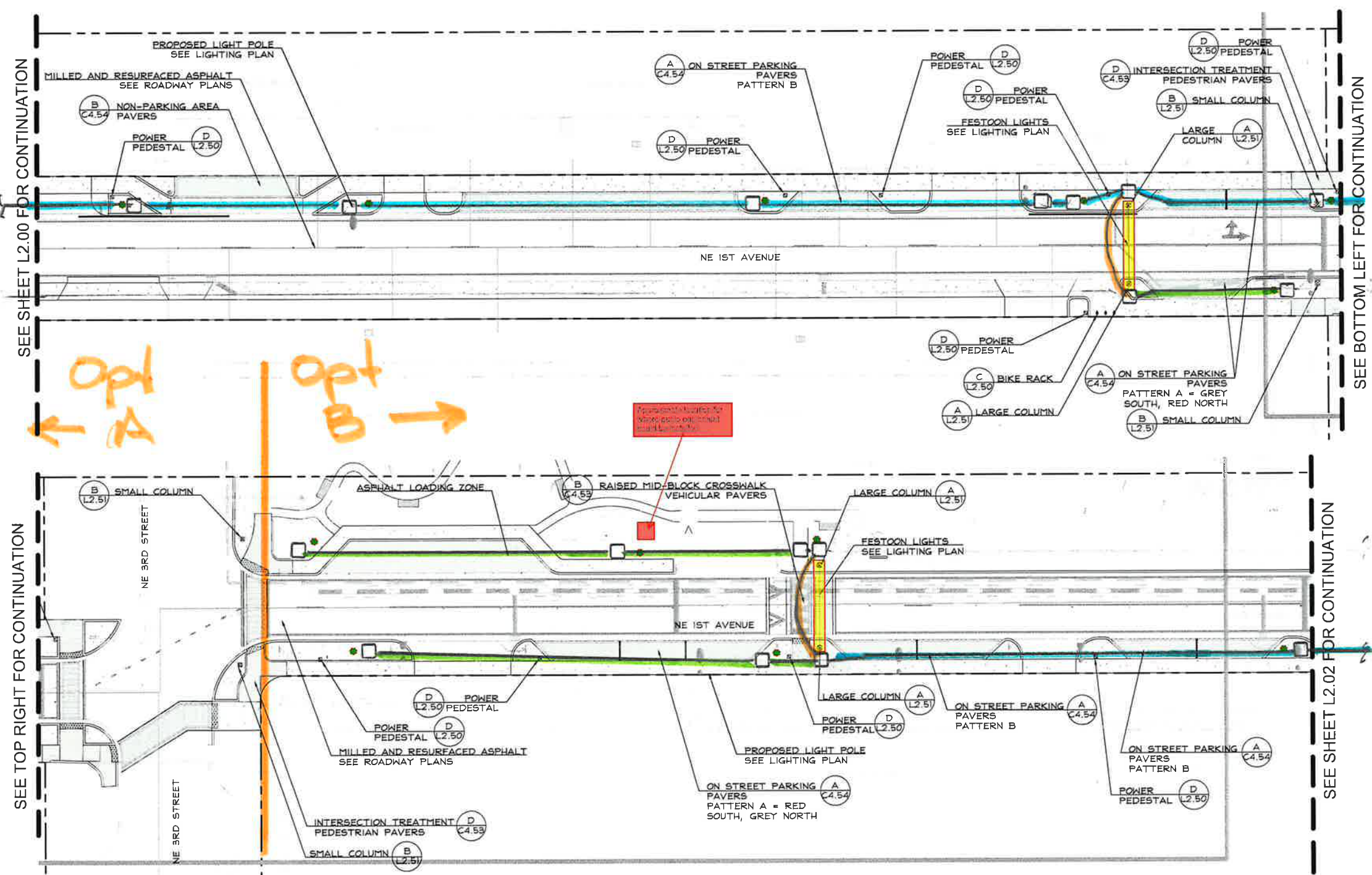

SEE SHEET L2.00 FOR CONTINUATION

SEE TOP RIGHT FOR CONTINUATION

SEE BOTTOM LEFT FOR CONTINUATION

SEE SHEET L2.02 FOR CONTINUATION



LOCATION MAP  
SCALE: 1" = 400'

CALL 48 HOURS BEFORE YOU DIG

IT'S THE LAW! DIAL 811

Know what's below. Call before you dig.

SUNSHINE STATE ONE CALL OF FLORIDA, INC.

<b>HARDSCAPE PLAN</b> DISTRICT 8 - NE 1ST STREETSCAPE IMPROVEMENTS PREPARED FOR HALLANDALE BEACH CRA		SHEET NUMBER <b>L2.01</b>
PROJECT NUMBER 2410-0001	DATE FEB 2026	DRAWN BY JH
CLIENT JONATHAN D. HORN, P.L.A.	SCALE AS SHOWN	CHECKED BY JH
LICENSE NUMBER LA16553795	PROJECT NAME DISTRICT 8 - NE 1ST STREETSCAPE IMPROVEMENTS	DATE 2/13/2026
COMPANY <b>Kimley»Horn</b>	ADDRESS 2025 4-WAY DRIVE, FORT WORTH, TEXAS 76102 1920 W. VA. WAY, SUITE 200, WEST PALM BEACH, FL 33411 PHONE: 561-975-0686 FAX: 561-863-8175 WWW.KIMLEY-HORN.COM CA 0000086	REVISIONS No. DATE BY

This document, together with the concepts and designs presented herein, is an instrument of service, as an instrument of service, as defined in Florida Statute 218.30, and shall be read and construed in accordance with the provisions of that statute. It is intended only for the specific purpose and client for which it was prepared. No part of this document shall be reproduced or transmitted in any form or by any means, electronic, mechanical, photocopying, recording, or by any information storage and retrieval system, without the prior written permission of Kimley-Horn and Associates, Inc. All rights reserved.

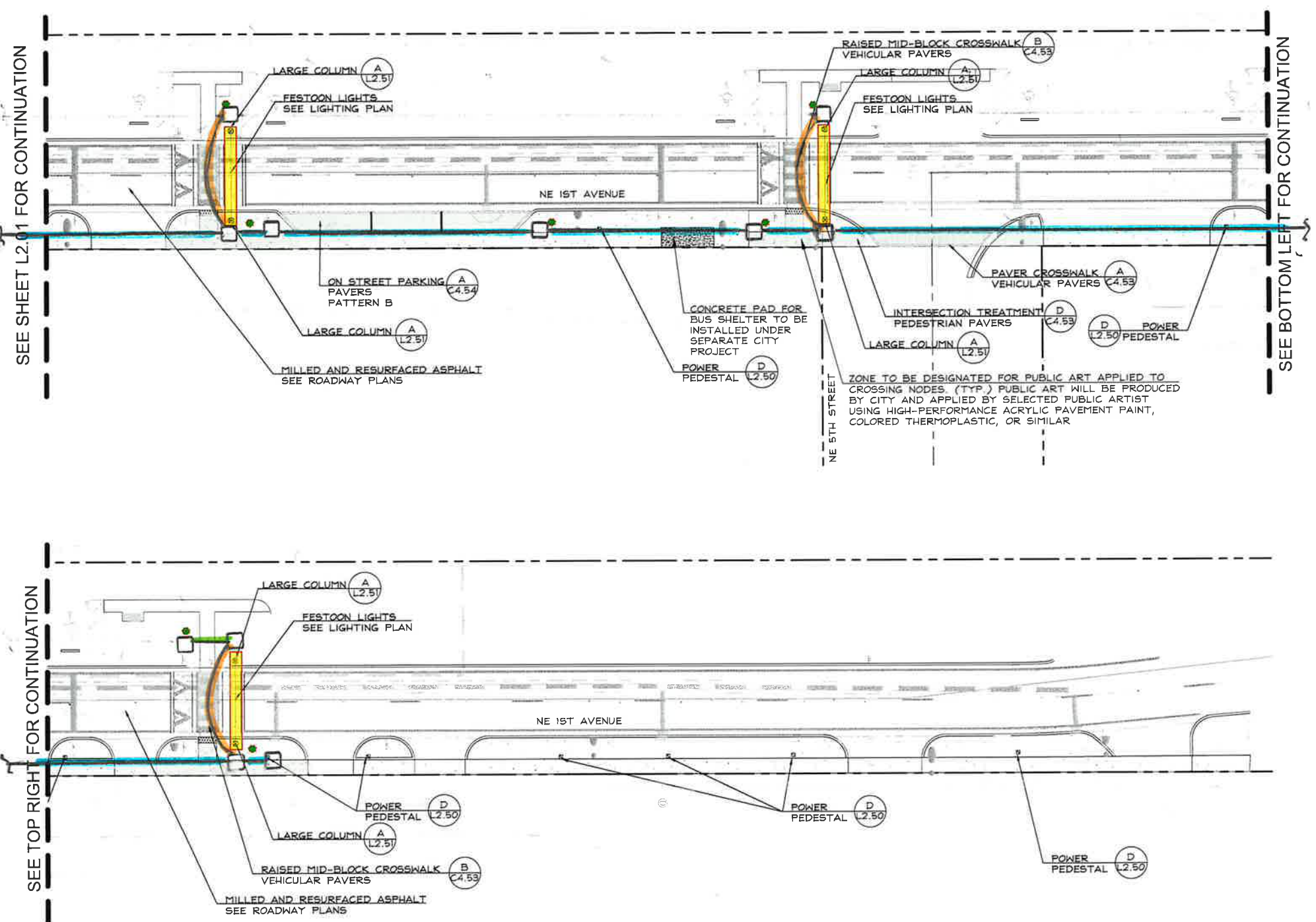

SEE TOP RIGHT FOR CONTINUATION

SEE BOTTOM LEFT FOR CONTINUATION



LOCATION MAP  
SCALE: 1" = 400'

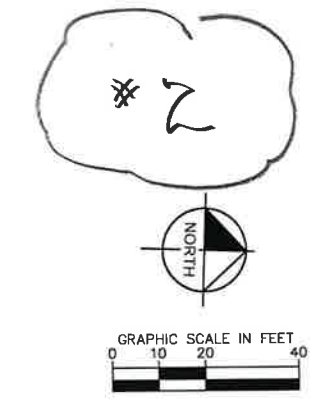

CALL 48 HOURS BEFORE YOU DIG

**811**

IT'S THE LAW! DIAL 811

Know what's below. Call before you dig.

FLORIDA STATE ONE CALL OF FLORIDA, INC.

<p><b>Kimley»Horn</b></p> <p>© 2025 - KIMLEY-HORN AND ASSOCIATES, INC. 1920 W. VA. WAY, SUITE 200, WEST PALM BEACH, FL 33411 PHONE: 561-973-0865 FAX: 561-863-8175 WWW.KIMLEY-HORN.COM CA 00030590</p>	
<p>KHA PROJECT: 2410-C001</p> <p>DATE: FEB 2026</p> <p>SCALE: AS SHOWN</p> <p>DRAWN BY: JH</p> <p>CHECKED BY: JH</p> <p>DATE: 2/13/2026</p>	<p>LICENSED PROFESSIONAL ENGINEER</p> <p>JOYATHAN D. HATH, P.E.</p> <p>FLORIDA LICENSE NUMBER: LA#6666795</p>
<p><b>HARDSCAPE PLAN</b></p>	
<p>DISTRICT 8 - NE 1ST STREETSCAPE IMPROVEMENTS PREPARED FOR HALLANDALE BEACH CRA</p>	
<p>SHEET NUMBER</p> <p><b>L2.02</b></p>	
<p>REVISIONS</p>	<p>DATE</p>



**ER Tech Systems Group Inc.**

2450 NW 36th Street  
 Ste 1A  
 Pompano Beach, FL 33073 US  
 +15615784964  
 admin@broadcastsystemsinc.com  
 www.broadcastsystemsinc.com

**Estimate**

ADDRESS	SHIP TO	SHIP VIA	GROUND	ESTIMATE	9096
BURKHARDT CONSTRUCTION, INC. 1400 Alabama Avenue, Suite 20 West Palm Beach, FL 33401	BURKHARDT CONSTRUCTION, INC. 1400 Alabama Avenue, Suite 20 West Palm Beach, FL 33401			DATE	03/15/2026

SALES REP  
 Nicholas Ehr

ACTIVITY	DESCRIPTION	QTY	RATE	AMOUNT
	OPTION 2B: 3rd St to northern limit of project: Ground-mounted speakers – installed in landscape areas			
Atlas IED	Atlas IED All Weather Outdoor Landscape Speaker with Short Base and 32-Watt 70V Transformer GSS-G TAP 32W @70V	25	921.193537 3	23,029.84T
Atlas IED	Atlas IED Dual-Channel, 1300-Watt Commercial Amplifier HPA1302	1	1,718.95	1,718.95T
BrightSign	BrightSign AU335 Audio Player IP Based with web control	1	165.00	165.00T
Job Materials	Peplink BR mini with din rail kit, extended range ANTENNA, AND POWER SUPPLY	1	1,120.00	1,120.00T
Job Materials	APC SMT1000RM1U Smart-UPS Line Interactive, Rack-Mountable, 1000VA, LCD Display	1	1,038.906	1,038.91T
Job Materials	BrightSign Cloud management software 1 year subscription DDB OD-16DDC 18"H x 28"W x 39"D (7 RU*) enclosure DDB Wall mount DDB insulation kit DDB Locking kit 2 handles Pentair AC unit for enclosure SS version OVP HV surge LV Surge Mounting materials and other consumable items	1	8,791.83	8,791.83T
Job Materials	Wirepath SP-142-DB-500-BLK 14/2 Direct Burial Speaker Wire, 500' Drum, Black	10	499.99	4,999.90T
Master Tech	Master Tech 1 tech 5 days	40	130.00	5,200.00T
Technician	Technician 2 techs 5 days	80	100.00	8,000.00T
Programming	Programming	8	160.00	1,280.00T
Project Mgmt	Project Management	8	150.00	1,200.00T

Pricing does not include directional drill/ missile bore,  
permitting, and any delay claims by Ranger.

You can pay by ACH, there's no fee for this option  
All estimates are inclusive of materials and completion of labor known at the  
time of site inspection. If extra materials and hours are required after work has  
begun, Broadcast Systems will inform the customer as soon as this knowledge  
is obtained. Once approved, a 50% deposit is required for work to begin. We do  
accept credit cards for payment. However, there will be a charge of 3.5% of the  
total purchase.  
Permitting, design, and engineering fees will be billed at cost plus. 2%

SUBTOTAL	56,544.43
TAX	3,958.11
-----	
TOTAL	<b>\$60,502.54</b>

Accepted By

Accepted Date