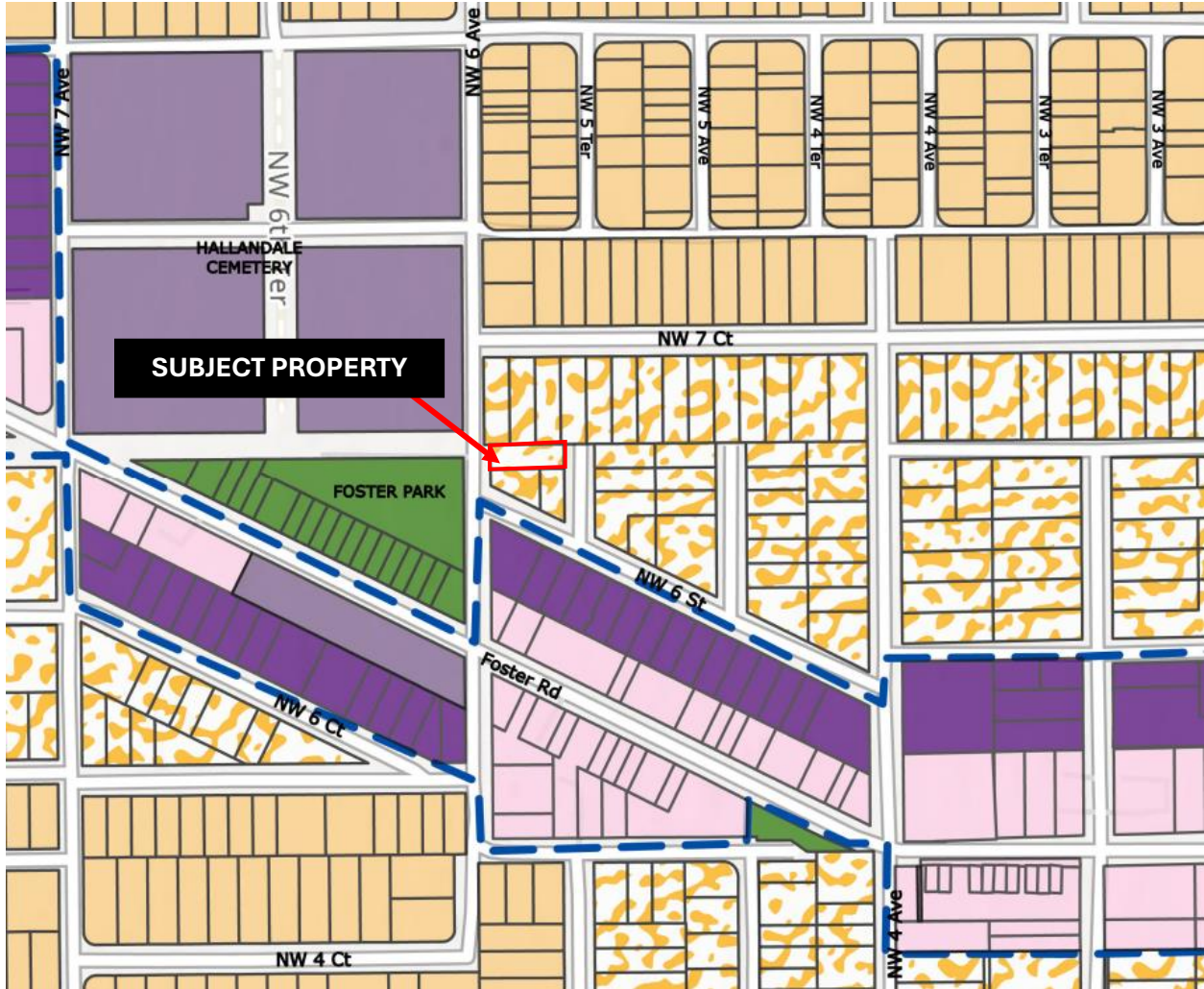

EXHIBIT 2 ZONING MAP



APPLICATION NO. V-24-06192
610 NW 6 AVENUE DUPLEX
VICTOR CABAN-DIAZ AND JOURNEY
C+D GROUP
610 NW 6 AVENUE

<ul style="list-style-type: none"> RESIDENTIAL SINGLE-FAMILY DISTRICT (RS-S) RESIDENTIAL SINGLE-FAMILY DISTRICT (RS-S) RESIDENTIAL SINGLE-FAMILY DISTRICT (RS-S) RESIDENTIAL TWO-FAMILY (DUPLEX) DISTRICT (RS-D-1) 	<ul style="list-style-type: none"> RESIDENTIAL MULTI-FAMILY (MEDIUM-DENSITY) DISTRICT (RM-18) RESIDENTIAL MULTI-FAMILY (MEDIUM-DENSITY) DISTRICT (RM-25) RESIDENTIAL MULTI-FAMILY (HIGH-DENSITY-2) DISTRICT (RM-HD-2) BUSINESS INDUSTRIAL DISTRICT (BI-1) 	<p style="text-align: center;">GENERAL DISTRICTS</p> <ul style="list-style-type: none"> COMMERCIAL RECREATIONAL (ACTIVE) DISTRICT (CR-A) COMMERCIAL RECREATIONAL (PASSIVE) DISTRICT (CR-P) BUSINESS LIMITED DISTRICT (B-1) INDUSTRIAL LIGHT DISTRICT (I-1) RECREATION AND OPEN SPACE DISTRICT (OS) EDUCATIONAL FACILITY DISTRICT (ED) EMPLOYMENT CENTER DISTRICT (EC) COMMUNITY FACILITY (CF) 	<ul style="list-style-type: none"> PLANNED LOCAL ACTIVITY CENTER DISTRICT (PLAC)
--	---	--	--